



***SWIFT***



# Holiday Homes

**2026 RANGE**



**Your Home Anywhere**

# Welcome to Swift

## UK's No.1 brand for leisure vehicles

We are the UK's largest manufacturer of touring caravans, motorhomes and holiday homes. We've grown from simple foundations back in 1964, when our founder Ken Smith built his first touring caravan, to become the UK's number one leisure vehicle brand.

Our philosophy is to build leisure vehicles that are at the heart of your holiday, whether that be nestled in the countryside or by the sea, searching out active pursuits or simply enjoying a quieter pace of life. With a lifetime of memories waiting to be made, it's time to find your ultimate holiday home.



## Contents

Five steps to ownership	4	Provence	26
Trends and design insights	5	Loire	30
The Swift Difference	6	Royan	34
Why Swift?	8	Features at a glance	38
Margaux	10	Dimensions & bed sizes	39
Bordeaux	14	Swift Eco optional extras	40
Morlaix	18	Exterior finishes	42
Burgundy	22	Swift approved partners	43



# Five steps to holiday home ownership

Owning a holiday home means more getaways and lasting memories, but knowing where to start can be daunting. That's why we've created a simple guide to help you choose the right home and park for your ideal escape.

## Step 1

### Is Holiday Home Ownership Right for You?

If you enjoy regular getaways, spending time with loved ones, or unwinding in peaceful surroundings, holiday home ownership could be ideal. It's perfect for walkers, cyclists, wildlife lovers - or anyone who values freedom and flexibility.

## Step 2

### Finding Your Dream Park

Choosing the right park is key. Consider what's important to you, whether that's nature, the seaside, or nearby attractions. Take your time exploring options on our destinations page to find a location you'll love for years to come.

## Step 3

### Visiting the Parks

Once you've narrowed it down, visit a few parks to get a feel for the atmosphere, facilities, and surroundings. It's the best way to picture yourself there and find the perfect spot for your holiday home.

## Step 4

### Choosing Your Holiday Home

Swift holiday homes combine smart design, practical features, and options for every lifestyle—from simple comfort to luxury touches. Choose the model that suits you best.

## Step 5

### What Happens Next?

Your park and dealer handle delivery and setup. At handover, they'll show you how everything works, so you can settle in and start enjoying your new getaway.

# Expertly designed and crafted



**Caroline Ward**  
Designer at Swift

We follow research insights and trends to keep ahead of the designs that appeal to both today's and tomorrow's customers, while also taking the time to understand what design aspects are important to you and your holiday lifestyle.

Today's trends involve a higher degree of ecological and environmental considerations, and at Swift, we share these values in our design and manufacturing decisions. We aim to replicate the natural world in both colour and material choices across all of our products.

Keeping on top of the trends through observation and research, we have seen a shift towards bolder accent colours as well as with colour palettes embracing warmer and softer earthy hues.

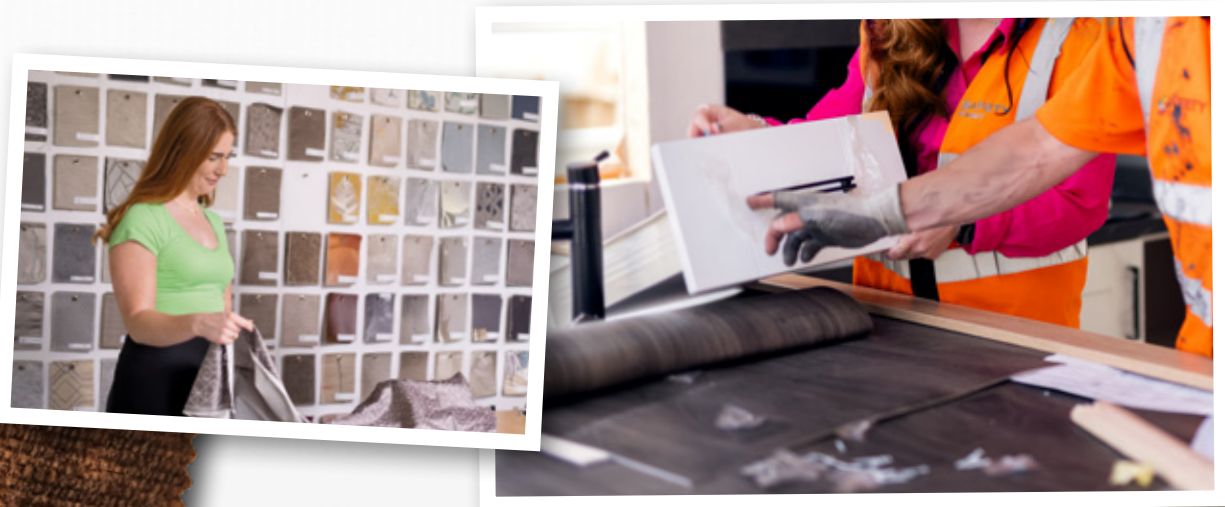



# The Swift Difference

There's no better feeling than stepping into your holiday home or lodge for a relaxing getaway, so we do everything possible to make that feeling last for years to come.

We pride ourselves on applying superior manufacturing quality to everything we produce, we deliberately make design choices for the interiors to prioritise "liveability." This ensures that our products not only endure the test of time but also provide comfort and usability for a truly enjoyable experience.

And prioritising your peace of mind, we offer outstanding warranties, including a 3-year Manufacturer Supersure Warranty, 5-year Structural Warranty and 10-year Chassis Warranty.



## Every Swift Holiday Home comes with the following as standard



### Exclusive Duvalay™ mattresses

All beds feature indulgent Duvalay™ mattresses for the best nights' sleep



### High thermal efficiency

Enjoy outstanding thermal efficiency, proven by environmental chamber testing and calculations

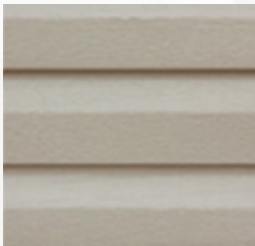

### Bonded exterior walls

Sandwich construction walls provide a more rigid exterior, bonded using a production method unique to Swift



### Integrated fridge freezers

Integrated fridge freezers are included across all ranges to maintain a sleek, uncluttered look (except Royan)



### Double electric and USB (A&C) sockets

Stay connected with electrical and USB sockets in selected areas keeping everything charged

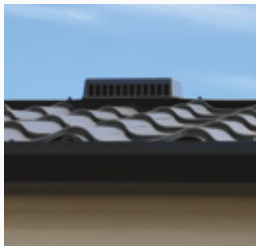

### Externally vented extractors

Keep your holiday home fresh and dry with externally vented extractors, preventing damp and odours

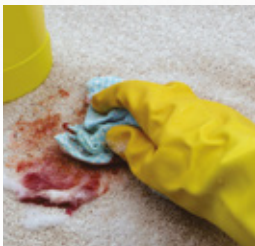

### Stain resistant carpets

With stain resistant carpets, there's no need to waste your precious holiday time scrubbing

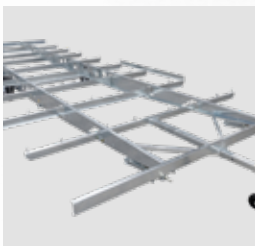

### Fully galvanised chassis

Protecting your holiday home, Swift's robust, fully galvanised chassis resist corrosion and is warrantied for 10 years



### LED ceiling lights

Benefitting the environment and your pocket, bright, low energy LED lighting is included throughout



### Integrated microwaves

Optimising valuable work surface space, all Swift Holiday Homes feature integrated microwaves (except Royan)



Scan the QR code for more information



# Why Swift?

As a leading manufacturer of holiday homes, touring caravans and motorhomes, we know just how to create the perfect retreat for your getaways. We apply this understanding in superb specifications, impeccable looks and creative space solutions, and work with a selection of the industry's most trusted suppliers.

As part of this manufacturing commitment, we defined the Swift Difference where we ensure that every holiday home and lodge that we produce meets our high quality and specification requirements.



## 1. Construction and thermal efficiency

Built to BS EN 1647 standards, Swift Holiday Homes meet NCC thermal and structural requirements.

## 2. Safety comes first

Audited by the National Caravan Council (NCC), all Swift Holiday Homes comply with British and European safety standards.

## 3. Double Glazing

Standard or optional heat-reflecting Thermaglas double glazing provides superior thermal performance with a 16mm air space.

## 4. Chassis

Fully galvanised chassis with a 10-year anti-corrosion warranty is standard on all Swift Holiday Homes.

## 5. Roof trusses

Prefabricated trusses ensure strength and accuracy, meeting Grade B snow loading (half a metre of settled snow) with glass wool insulation for excellent thermal efficiency.

## 6. Wall construction

Bonded sandwich walls with a timber frame, insulation, and plywood inner skin are clad in durable aluminium or CanExel for enhanced strength.

## 7. Floor construction

Timber joists with 80mm glass wool insulation are covered with a breathable membrane and waterproof finish for durability.



## 3-Year Supersure Warranty

Your holiday home has 3-year cover for all parts and fittings (other than the structural exterior). This includes items like:

- Freestanding furniture
- Kitchens
- Showers
- Sanitaryware
- Sockets and switches
- Interior doors and integrated furniture
- Gutter and fall pipes



## 5-Year Structural Warranty

Your holiday home is protected by a 5-year Structural Warranty. Swift will repair or replace any structural defects, including issues with sealed seam joints or water ingress, reported within the warranty period. Coverage extends to key components, such as:

- External doors
- uPVC windows
- Roof, walls and ceilings
- Carpets
- Morco boilers



## 10-Year Chassis Warranty

Your holiday home has a fully galvanised chassis with a 10-year Chassis Warranty, subject to maintenance. Swift will repair (or, at its option, replace) any defects with the chassis that come to light during this period, only for as long as the home belongs to its first owner.

All warranties start from the date an approved Swift Group dealer or park operator transfers the unit to its first owner and are subject to conditions, terms and exclusions. For full details see [swiftholidayhomes.co.uk/owners](https://www.swiftholidayhomes.co.uk/owners)



# Margaux



The Margaux is designed to impress with its luxurious townhouse interior and modern vibe. Featuring a bright interior, highlighted by a full-height front aspect window and a stunning kitchen, equipped with integrated high-spec appliances, the Margaux is the perfect space for entertaining.



5 layouts



2-3 bedrooms



Sleeps 4-8

## Key highlights



Large front aspect window



Sofa bed



Ample wardrobe space



USB (A&C) sockets throughout



Vanity area with mirror



Premium lodge feel in holiday home dimensions



## Margaux layouts

35' x 12' - 2 Bedroom

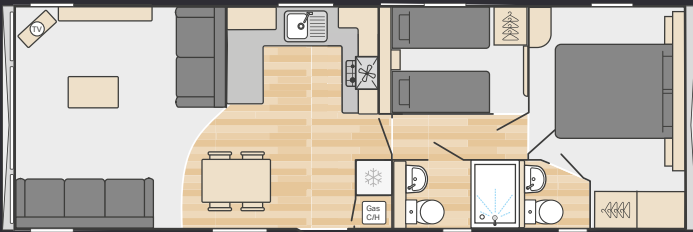

38' x 12' - 2 Bedroom

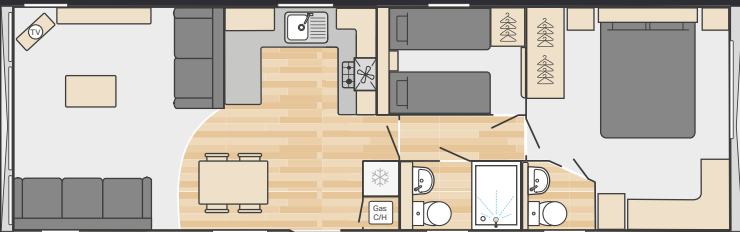

38' x 12' ES - 2 Bedroom

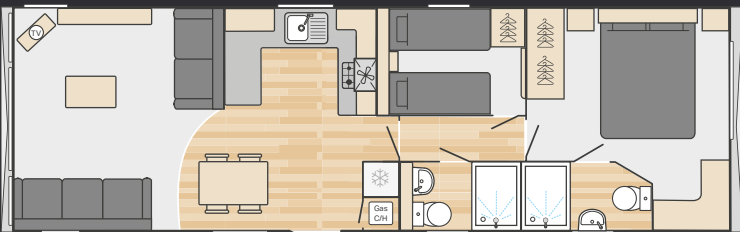

38' x 12' - 3 Bedroom

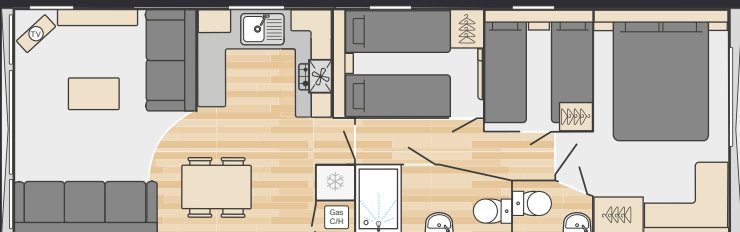

39' x 12' ES - 3 Bedroom



Scan the QR code to explore more or visit [swiftholidayhomes.co.uk](https://www.swiftholidayhomes.co.uk)





## Margaux highlights

In addition to the Swift Standard features detailed on pages 6 and 7, Margaux also includes the following features as standard. For more full features, visit [swift-holidayhomes.co.uk](https://www.swift-holidayhomes.co.uk).

### Exterior

- Woodgrain textured Sandy Beige aluminium cladding
- White uPVC windows with push-button security locks
- Low energy exterior side light
- Full height front aspect fixed window

### Insulation

- Thermaglas uPVC double glazing
- Excellent thermal performance throughout

### Interior

- Condensing gas combi-boiler central heating and hot water system with radiator thermostats
- Luxury carpet with underlay throughout lounge and bedrooms
- Provenza vinyl flooring in kitchen/dining/washrooms
- Tobacco Halifax oak woodgrain with Indigo feature panels and Light Grey furniture
- Low energy LED lighting throughout

- Lined curtains on poles and voiles to lounge and bedrooms

### Lounge

- Freestanding two-piece suite with fold out occasional bed and matching footstool
- Wall unit with shelving and storage cupboards
- Freestanding TV unit with drawer
- TV points with Co-Ax and 240V socket
- Large round mirror and Town House framed wall picture

### Kitchen / Dining

- Stylish U-shaped kitchen with soft close doors and drawers
- Levanto 40mm marble effect worktops with white tile effect splashback
- Glass fronted oven and grill with electronic ignition
- Four-burner gas hob with electronic ignition
- White cast resin bowl with drainer and brushed steel tap
- Integrated microwave oven (800w) and fridge/freezer

- Freestanding dining table and chairs

### Main Bedroom

- King size lift up bed with padded headboard and Duvalay™ Aurora mattress (Double bed in 3 bed models)
- Double wardrobe and bedside tables with reading lights
- TV socket & Co-Ax

### Additional Bedroom(s)

- Twin beds with padded headboards and Duvalay™ Aurora mattresses
- Single wardrobe, overhead storage and bedside table with wall downlight
- TV socket & Co-Ax

### Washroom(s)

- Shower cubicle with thermostatic shower
- Dual flush WC
- Extractor fan (main washroom)
- Shaving socket (main washroom)

## Margaux optional extras

These optional extras are available to enhance your Margaux even further. Make a note of which extras you require so your park or distributor can include them in your quote.

- ☐ Front aspect single sliding door
- ☐ Front aspect double sliding door
- ☐ Standard aluminium cladding with Anthracite window frames
- ☐ Environmental Green aluminium cladding with Anthracite window frames
- ☐ Brown aluminium cladding with Anthracite window frames
- ☐ Bluetooth® audio connection to lounge ceiling speakers
- ☐ Integrated slim-line dishwasher
- ☐ Contemporary 2kw Voltino fire with flame effect and remote control
- ☐ Gazunda bed in all twin bedrooms for extra space (one bed stores under the other when not required)
- ☐ Swift Smart Command System (see pages 40 and 41 for details)



# Bordeaux



Well-appointed and stylish, Bordeaux is available in a choice of two or three bedrooms, offering contemporary accommodation for the whole family.

-  4 layouts
-  2-3 bedrooms
-  Sleeps 4-8

## Key highlights

-  Large windows
-  Choice of TV positions
-  Sofa bed
-  USB (A&C) sockets throughout
-  Space-saving overbed storage
-  Large vanity area with mirror



# Bordeaux layouts

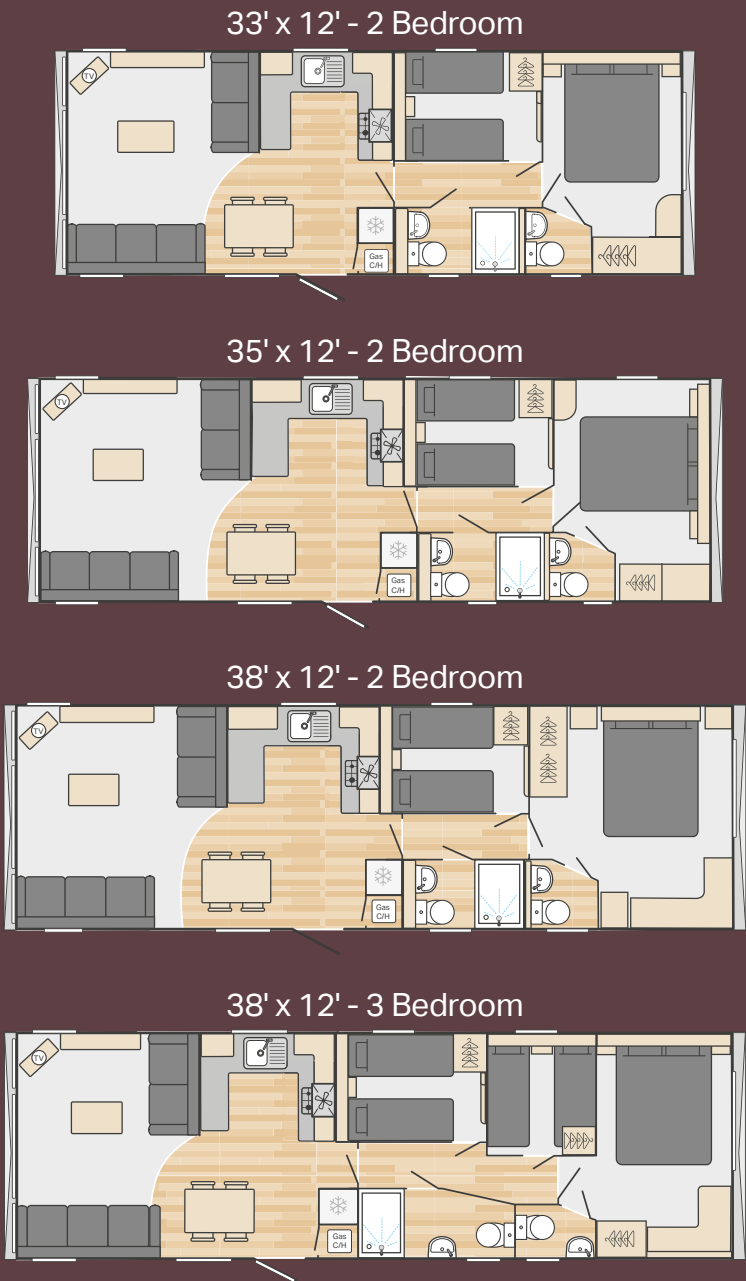

Scan the QR code to explore more or visit [swiftholidayhomes.co.uk](https://www.swiftholidayhomes.co.uk)





## Bordeaux highlights

In addition to the Swift Standard features detailed on pages 6 and 7, Bordeaux also includes the following features as standard. For more full features, visit [swiftholidayhomes.co.uk](http://swiftholidayhomes.co.uk).

### Exterior

- Woodgrain textured Sandy Beige aluminium cladding
- White uPVC windows with push-button security locks
- Low energy exterior side light
- Full height front aspect fixed window

### Insulation

- Thermaglas uPVC double glazing
- Excellent thermal performance throughout

### Interior

- Condensing gas combi-boiler central heating and hot water system with radiator thermostats
- Luxury carpet with underlay throughout lounge and bedrooms
- Laminate effect vinyl flooring in kitchen/dining/washrooms
- Nebraska Oak woodgrain
- Low energy LED lighting throughout
- Voiles to lounge and bedrooms

### Lounge

- Freestanding two-piece suite with fold out occasional bed and scatter cushions
- Lounge wall unit
- Freestanding TV unit with drawer
- TV points with Co-Ax and 240V socket
- Coffee table with two upholstered cylindrical stools underneath
- Framed mirror and larger gold framed mirror

### Kitchen / Dining

- Stylish U-shaped kitchen with soft close doors and drawers
- Levanto marble effect worktops with white tile effect splashback
- Glass fronted oven, grill and electronic ignition
- Four-burner gas hob with electronic ignition
- White cast resin sink bowl and drainer with brass effect tap
- Integrated microwave oven (800w) and fridge/freezer

- Freestanding dining table and chairs

### Main Bedroom

- King size lift up bed with padded headboard and Duvalay™ Aurora mattress (Double bed in 33' 2 bed & 38' 3 bed models)
- Double wardrobe, overhead storage and bedside tables
- Vanity area with mirror
- TV sockets & Co-Ax

### Additional Bedroom(s)

- Twin beds with padded headboard and Duvalay™ Aurora mattresses
- Single wardrobe, overhead storage and bedside table
- TV sockets & Co-Ax plus booster

### Washroom(s)

- Shower cubicle with thermostatic shower
- Dual flush WC
- Extractor fan (main washroom)
- Shaving socket (main washroom)

## Bordeaux optional extras

These optional extras are available to enhance your Bordeaux even further. Make a note of which extras you require so your park or distributor can include them in your quote.

- ❑ Front aspect sliding door
- ❑ Integrated slim-line dishwasher
- ❑ Standard aluminium cladding with Anthracite window frames
- ❑ Environmental Green aluminium cladding with Anthracite window frames
- ❑ Brown aluminium cladding with Anthracite window frames
- ❑ Bluetooth® audio connection to lounge ceiling speakers
- ❑ Electric Fire
- ❑ Gazunda bed in all twin bedrooms for extra space (one bed stores under the other when not required)
- ❑ Swift Smart Command System (see pages 40 and 41 for details)



# Morlaix



Discover the Morlaix – boasting a charming farmhouse interior and a cosy ambiance throughout. With neutral tones accented by Tobacco Halifax Oak woodgrain features, this stylish holiday home is right on trend, providing the perfect retreat for the whole family.



3 layouts



2 bedrooms



Sleeps 4-6

## Key highlights



Stylish soft  
furnishing scheme



Spacious  
L-shaped sofa



Family-friendly  
dining area



USB (A&C)  
sockets  
throughout



Ample wardrobe  
space



Vanity area  
with mirror



## Morlaix layouts

36' x 12' - 2 Bedroom

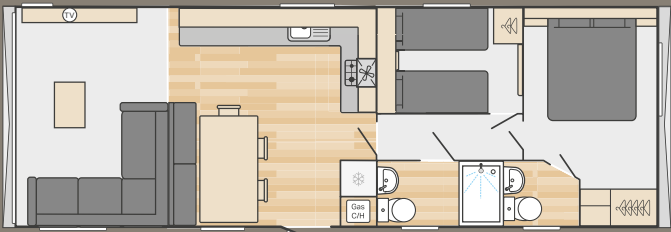

38' x 12' - 2 Bedroom

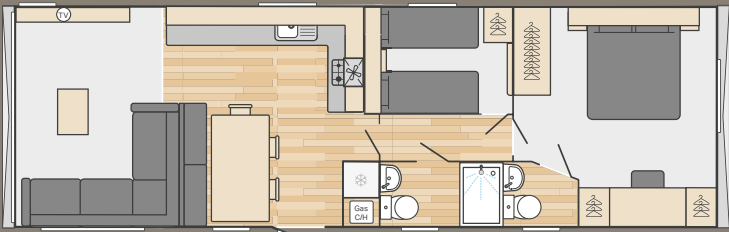

40' x 12' - 3 Bedroom

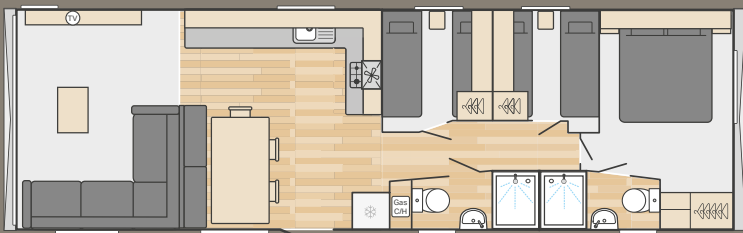

Scan the QR code to  
explore more or visit  
[swiftholidayhomes.co.uk](https://www.swiftholidayhomes.co.uk)





## Morlaix highlights

In addition to the Swift Standard features detailed on pages 6 and 7, Morlaix also includes the following features as standard. For more full features, visit [swiftholidayhomes.co.uk](http://swiftholidayhomes.co.uk).

### Exterior

- Woodgrain textured Sandy Beige aluminium cladding
- White uPVC windows with push-button security locks
- Low energy exterior side light
- Full height front aspect fixed window

### Insulation

- Thermaglas uPVC double glazing
- Excellent thermal performance throughout

### Interior

- Condensing gas combi-boiler central heating and hot water system with radiator thermostats
- Luxury carpet with underlay throughout lounge and bedrooms
- Provenza grey toned vinyl flooring in kitchen/dining/washrooms
- Truffle Brown woodgrain
- Low energy LED lighting throughout
- Lined curtains on poles to lounge and bedrooms

### Lounge

- Fixed L-shaped sofa with fold out occasional bed and scatter cushions
- TV unit with storage and overhead decorative shelf
- Coffee table
- TV points with Co-Ax and 240V socket
- Nature Wall room divider

### Kitchen / Dining

- Shaker style kitchen doors and feature shelving
- 30mm Tobacco Halifax oak worktops with matching splashback
- Glass fronted oven and grill with electronic ignition
- Four-burner gas hob with electronic ignition
- White cast resin sink bowl and drainer with brushed steel tap
- Integrated microwave oven (800w) and fridge/freezer
- Freestanding dining table with fixed bench seating and three freestanding chairs

### Main Bedroom

- King size lift up bed with padded headboard and Duvalay™ Aurora mattress
- Double wardrobe and bedside tables
- Vanity area with mirror
- TV socket & Co-Ax

### Additional Bedroom(s)

- Twin beds with padded headboards and Duvalay™ Aurora mattresses
- Single wardrobe, overhead storage and bedside table
- TV socket & Co-Ax

### Washroom(s)

- Shower cubicle with thermostatic shower
- Dual flush WC
- Extractor fan (main washroom)
- Shaving socket (main washroom)

## Morlaix optional extras

These optional extras are available to enhance your Morlaix even further. Make a note of which extras you require so your park or distributor can include them in your quote.

- ❑ Front aspect single sliding door
- ❑ Standard aluminium cladding with Anthracite window frames
- ❑ Environmental Green aluminium cladding with Anthracite window frames
- ❑ Brown aluminium cladding with Anthracite window frames
- ❑ Bluetooth® audio connection to lounge ceiling speakers
- ❑ Integrated slim line dish washer
- ❑ Voiles to lounge and bedrooms
- ❑ Assisted lift up master bed with storage below
- ❑ Gazunda bed in twin bedrooms for extra space (one bed stores under the other when not required)
- ❑ Coffee table with upholstered stools
- ❑ Swift Smart Command System (see pages 40 and 41 for details)



# Burgundy



New for 2026, the Burgundy combines a fresh, soft interior palette with contemporary touches - think fresh mint green, Terrazzo style details and hints of gold. Spacious and smartly laid out, it's a great choice for families who want a stylish holiday home but enjoy their home from home comforts.

-   
6 layouts
-   
2-3 bedrooms
-   
Sleeps 4-8

### Key highlights

-   
Space-saving overbed storage
-   
Sofa bed
-   
Spacious L-shaped sofa
-   
Freestanding dining table and chairs
-   
Vanity area with mirror
-   
USB (A&C) sockets throughout



## Burgundy layouts

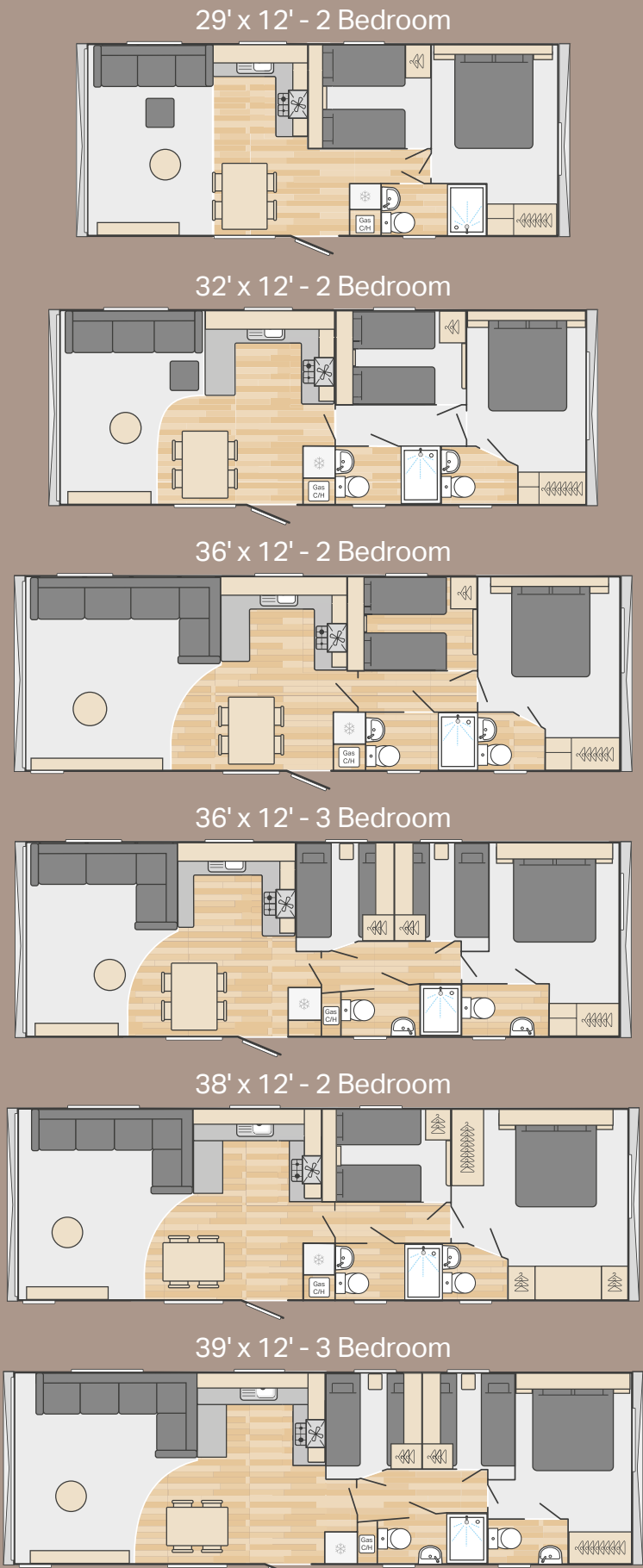

Scan the QR code to explore more or visit [swiftholidayhomes.co.uk](https://www.swiftholidayhomes.co.uk)





## Burgundy highlights

In addition to the Swift Standard features detailed on pages 6 and 7, Burgundy also includes the following features as standard. For more full features, visit [swift-holidayhomes.co.uk](https://www.swift-holidayhomes.co.uk).

### Exterior

- Woodgrain textured Sandy Beige aluminium cladding
- White uPVC windows with push-button security locks
- Low energy exterior side light
- Full height front aspect fixed window

### Insulation

- Thermaglas uPVC double glazing
- Excellent thermal performance throughout

### Interior

- Condensing gas combi-boiler central heating and hot water system with radiator thermostats
- Luxury carpet with underlay throughout lounge and bedrooms
- Herringbone effect vinyl flooring in kitchen/dining/washrooms
- Nebraksa Oak woodgrain with Almond Beige feature panels
- Low energy LED lighting throughout

- Lined curtains on gold poles to lounge and bedrooms

### Lounge

- Fixed sofa with fold out occasional bed, scatter cushions and large footstool (29ft and 32ft models)
- TV unit with storage and shelving
- TV point with Co-Ax and 240V socket
- Scenic side window next to TV surround (38' and 36' 2 bed models only)
- Round coffee table

### Kitchen / Dining

- Modern U-shaped kitchen units with soft close doors and drawers
- Terrazzo Fresh 30mm laminate worktops with upstands and glass splashback
- Glass fronted oven, grill and electronic ignition
- Four-burner gas hob with electronic ignition
- White cast resin sink bowl and drainer with Gold tap

- Integrated microwave oven (800w) and fridge/freezer
- Freestanding dining table and chairs

### Main Bedroom

- King size bed with feature headboard and Duvalay™ Aurora mattress
- Double wardrobe, overhead storage and bedside tables
- Vanity area with mirror
- TV socket & Co-Ax

### Additional Bedroom(s)

- Twin beds with feature headboards and Duvalay™ Aurora mattresses
- Single wardrobe, overhead storage and bedside table
- TV socket & Co-Ax

### Washroom(s)

- Shower cubicle with thermostatic shower
- Dual flush WC
- Extractor fan (main washroom)
- Shaving socket (main washroom)

## Burgundy optional extras

These optional extras are available to enhance your Burgundy even further. Make a note of which extras you require so your park or distributor can include them in your quote.

- ❑ Front aspect sliding door
- ❑ Standard aluminium cladding with Anthracite window frames
- ❑ Environmental Green aluminium cladding with Anthracite window frames
- ❑ Brown aluminium cladding with Anthracite window frames
- ❑ Bluetooth® audio connection to lounge ceiling speakers
- ❑ Assisted lift up master bed with storage below
- ❑ Integrated slim line dishwasher
- ❑ Upgraded coffee table with two upholstered stools
- ❑ Voiles to the lounge and bedrooms
- ❑ Gazunda bed in all twin bedrooms for extra space (one bed stores under the other when not required)
- ❑ Swift Command system (see pages 40 and 41 for details)









# Provence



The Provence offers a calming countryside escape. Available in two models, the Provence Bay features a panoramic bay window, while the Provence Outlook includes a full-height front window with an alternative lounge configuration. With neutral soft furnishings, stylish design touches, and an abundance of space throughout, the Provence is a relaxing and practical home you'll love returning to.

-  6 layouts
-  2-3 bedrooms
-  Sleeps 4-8

## Key highlights

-  Bay window, glazed front or sliding doors
-  Sofa bed
-  Space-saving Gazunder bed
-  USB (A&C) sockets throughout
-  Ample wardrobe space
-  Electric log burner style fire



Provence Outlook layout



Provence Bay layout

## Provence layouts

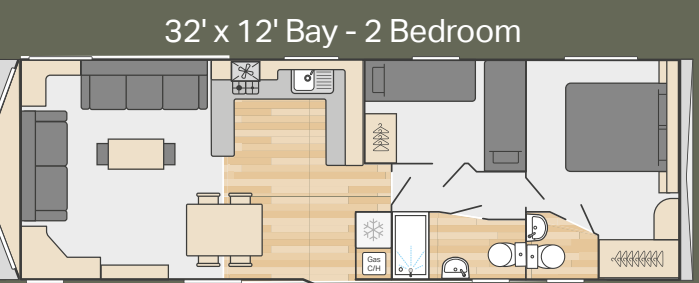

Scan the QR code to explore more or visit [swiftholidayhomes.co.uk](https://www.swiftholidayhomes.co.uk)





Provence Bay layout



Provence Bay layout



## Provence highlights

In addition to the Swift Standard features detailed on pages 6 and 7, Provence also includes the following features as standard. For more full features, visit [swiftholidayhomes.co.uk](http://swiftholidayhomes.co.uk).

### Exterior

- Woodgrain textured Sandy Beige aluminium cladding
- White UPVC double glazed windows with push-button security locks
- Low energy exterior side light
- Front bay window OR Full height front aspect fixed window

### Insulation

- Thermaglas uPVC double glazing
- Excellent thermal performance throughout

### Interior

- Condensing gas combi-boiler central heating and hot water system with radiator thermostats
- Luxury carpet with underlay throughout lounge and bedrooms
- Mill Oak Grege vinyl flooring in kitchen/dining/washrooms
- Nebraksa Oak woodgrain with Agave Green feature panels and Stone Grey furniture

- Low energy LED lighting throughout
- Lined curtains on poles and voiles to lounge and bedrooms

### Lounge

- Freestanding 3 and 2 seater sofas with scatter cushions (3 seater with fold out occasional bed)
- Coffee table with upholstered footstools
- Contemporary electric fire
- Corner TV unit with storage
- Framed wall picture

### Kitchen / Dining

- Shaker style kitchen cupboards with soft close doors and drawers
- Sand Grey Calvia Stone 40mm laminate worktops with metal splashback
- Glass fronted oven and grill with electronic ignition
- Four-burner gas hob with electronic ignition
- White cast resin sink bowl and drainer with brass tap
- Integrated microwave oven (800w) and fridge/freezer

- Freestanding dining table and chairs

### Main Bedroom

- Double lift up bed with feature headboard and Duvalay™ Aurora mattress
- Double wardrobe, overhead storage and bedside tables
- Vanity area with mirror
- TV socket & Co-Ax

### Additional Bedroom(s)

- Twin beds with feature headboards and Duvalay™ Aurora mattresses
- Gazunda bed in one twin bedroom for extra space (2 bed model)
- Single wardrobe, overhead storage and bedside table
- TV sockets & Co-Ax

### Washroom(s)

- Shower cubicle with thermostatic shower
- Dual flush WC
- Extractor fan (main washroom)
- Shaver socket (main washroom)

## Provence optional extras

These optional extras are available to enhance your Provence even further. Make a note of which extras you require so your park or distributor can include them in your quote.

- ❑ Standard aluminium cladding with Anthracite window frames
- ❑ Environmental Green aluminium cladding with Anthracite window frames
- ❑ Brown aluminium cladding with Anthracite window frames
- ❑ Front sliding door (Provence Outlook only)
- ❑ Velux window with integrated blackout blind and pole in kitchen
- ❑ Bluetooth® audio connection to lounge ceiling speakers
- ❑ Integrated dishwasher
- ❑ Swift Command (see pages 40 and 41 for details)





# Loire



Designed with family living at its heart, the Loire is available in a range of sizes and bedroom layouts. With family-friendly accommodation, quality appliances and a hardwearing interior, Loire boasts a warm, practical interior that's built for regular getaways.



8 layouts



2-3 bedrooms



Sleeps 4-8

## Key highlights



Panoramic bay window



Sofa bed



Open plan layout



USB (A&C) sockets throughout



Family-friendly dining area



Ample wardrobe space



## Loire layouts

28' x 10' - 2 Bedroom

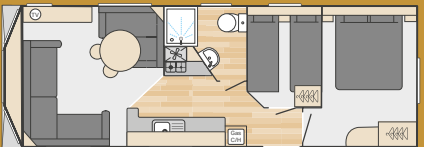

28' x 12' - 2 Bedroom

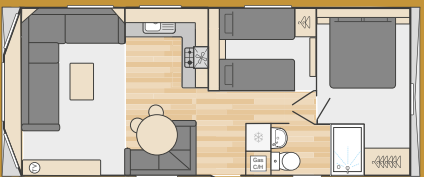

32' x 10' - 2 Bedroom



32' x 12' - 2 Bedroom

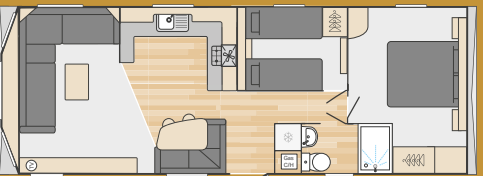

35' x 12' - 2 Bedroom

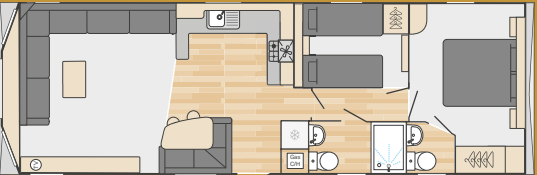

35' x 12' - 3 Bedroom

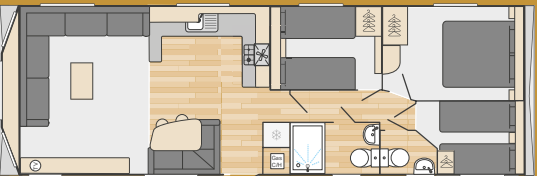

38' x 12' - 2 Bedroom

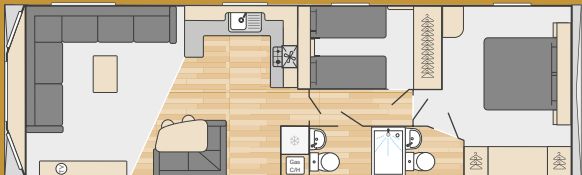

38' x 12' - 3 Bedroom

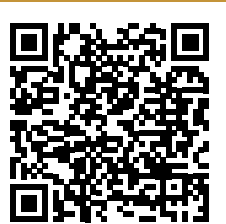
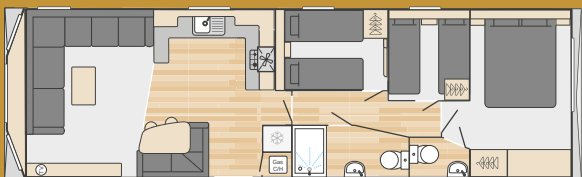

Scan the QR code to explore more or visit [swiftholidayhomes.co.uk](https://www.swiftholidayhomes.co.uk)





## Loire highlights

In addition to the Swift Standard features detailed on pages 6 and 7, Loire also includes the following features as standard. For more full features, visit [swiftholidayhomes.co.uk](http://swiftholidayhomes.co.uk).

### Exterior

- Woodgrain textured Sandy Beige aluminium cladding
- White uPVC windows with push-button security locks
- Low energy exterior side light
- Front bay window for wider panoramic views

### Insulation

- Thermaglas uPVC double glazing
- Excellent thermal performance throughout

### Interior

- Condensing gas combi-boiler central heating and hot water system with radiator thermostats
- Luxury carpet with underlay throughout lounge and bedrooms
- Herringbone Grege effect vinyl flooring in kitchen/dining/washrooms
- Tisano Oak woodgrain with Truffle brown feature panels
- Low energy LED lighting throughout

- Lined curtains with tiebacks on curtain poles to lounge and bedrooms

### Lounge

- Fixed L-shaped sofa with fold out occasional bed and scatter cushions
- Round coffee table (except 10ft models)
- TV unit with storage
- TV point with Co-Ax and 240V socket

### Kitchen / Dining

- Silver Chromix 30mm laminate worktops with matching upstands
- Glass fronted oven and grill with electronic ignition
- Four-burner gas hob with electronic ignition
- Stainless steel sink/drainage with NEW Manhattan brush steel tap
- Integrated microwave oven (800w) and fridge/freezer (12' models)
- Under counter fridge (10' models)

- Freestanding dining table with fixed style seating and two stools

### Main Bedroom

- Double bed with feature headboard and Duvalay™ Aurora mattress
- Double wardrobe, overhead storage and bedside tables
- Vanity area with mirror
- TV socket & Co-Ax (except 28' x 12' 2 bed)

### Additional Bedroom(s)

- Twin beds with feature headboards and Duvalay™ Aurora mattresses
- Single wardrobe, overhead storage and bedside table
- TV socket & Co-Ax (except 28' x 12' 2 bed)

### Washroom(s)

- Shower cubicle with thermostatic shower
- Dual flush WC
- Extractor fan (main washroom)
- Shaver socket (main washroom)

## Loire optional extras

These optional extras are available to enhance your Loire even further. Make a note of which extras you require so your park or distributor can include them in your quote.

- ❑ Standard aluminium cladding with Anthracite window frames
- ❑ Environmental Green aluminium cladding with Anthracite window frames
- ❑ Brown aluminium cladding with Anthracite window frames
- ❑ Assisted lift up master bed with storage below
- ❑ Freestanding dining table and freestanding chairs in place of fixed dinette
- ❑ Bluetooth® audio connection to lounge ceiling speakers
- ❑ Upgraded coffee table with two upholstered stools (replacing round coffee table)
- ❑ Integrated slim line dishwasher (12ft models only)
- ❑ Voiles to the lounge and bedrooms
- ❑ Swift Command system (see pages 40 and 41 for details)



# Royan



Meet the Royan, an affordable holiday home that delivers great value with looks to match. The Royan is designed with families in mind. Its spacious open-plan living area boasts a fresh Silas soft furnishings scheme, whilst clever storage saving solutions are found throughout, ensuring every inch is utilised efficiently.



3 layouts



2-3 bedrooms



Sleeps 4-8

## Key highlights



Front panoramic window



Spacious L-shaped sofa



Space-saving Gazunder bed



USB (A&C) sockets throughout



Customisable specification



Ample wardrobe space



## Royan layouts

28' x 12' - 2 Bedroom

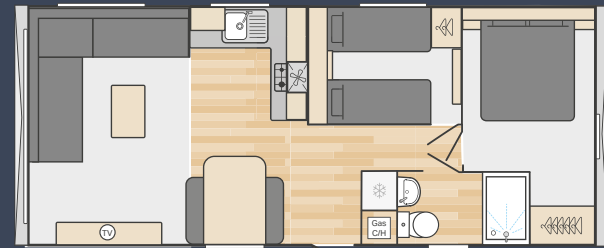

35' x 12' - 2 Bedroom

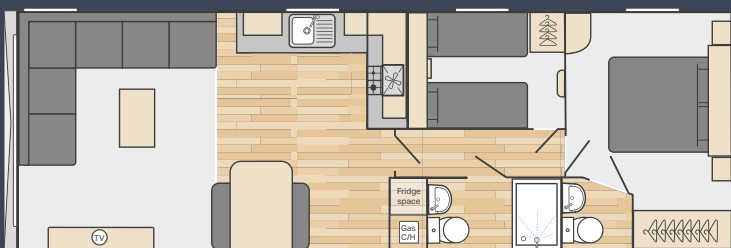

35' x 12' - 3 Bedroom

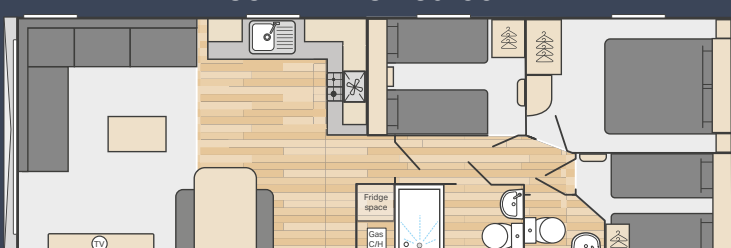

Scan the QR code to explore more or visit [swiftholidayhomes.co.uk](https://www.swiftholidayhomes.co.uk)







## Royan highlights

In addition to the Swift Standard features detailed on pages 6 and 7, Royan also includes the following features as standard. For more full features, visit [swiftholidayhomes.co.uk](http://swiftholidayhomes.co.uk).

### Exterior

- Woodgrain textured Sandy Beige aluminium cladding
- White uPVC windows with push-button security locks
- Low energy exterior side light
- Front flat window for wider panoramic views

### Insulation

- Excellent thermal performance throughout

### Interior

- Condensing gas combi-boiler central heating and hot water system with radiator thermostats
- Luxury carpet with underlay throughout the lounge and bedrooms
- Tournai Stone vinyl flooring in kitchen/dining/washrooms
- Tisano woodgrain with Dust Grey feature panels
- Low energy LED lighting throughout

- Printed curtains with curtain poles to lounge and bedrooms

### Lounge

- Fixed L-shaped sofa with scatter cushions
- Coffee table
- TV unit with storage
- TV point with Co-Ax and 240V socket

### Kitchen / Dining

- Sleek handle-less kitchen units to the ceiling
- Silver Chromix 30mm laminate worktops
- Glass fronted oven and grill with electronic ignition
- Four-burner gas hob with electronic ignition
- Stainless steel sink/drain
- Space for freestanding microwave and freestanding fridge/freezer
- Freestanding dining table with bench seating and seating cushions

### Main Bedroom

- Double bed with feature headboard and Cignus Duvalay™ mattress
- Double wardrobe, overhead storage and bedside tables
- Vanity area with mirror

### Additional Bedroom(s)

- Gazunda bed with feature headboards and Cirrus Duvalay™ mattresses in one twin bedroom for extra space (one bed stores under the other when not required)
- Single wardrobe, overhead storage and bedside table

### Washroom(s)

- Shower cubicle with thermostatic shower
- Dual flush WC
- Vanity mirror and shelf

## Royan optional extras

These optional extras are available to enhance your Royan even further. Make a note of which extras you require so your park or distributor can include them in your quote.

- ❑ Standard aluminium cladding with Anthracite window frames
- ❑ Environmental Green aluminium cladding with Anthracite window frames
- ❑ Brown aluminium cladding with Anthracite window frames
- ❑ Freestanding Fridge freezer
- ❑ Freestanding microwave
- ❑ Shaver socket in main washroom
- ❑ Shower room extractor fan
- ❑ Fold out occasional sofa bed
- ❑ Bluetooth® audio connection to lounge ceiling speakers
- ❑ Coffee table with upholstered fabric stools
- ❑ Voiles to lounge and bedrooms
- ❑ Lift up double bed in main bedroom
- ❑ TV point and booster in main bedroom with additional USB sockets throughout
- ❑ Swift Smart Command System (see pages 40 and 41 for details)
- ❑ Royan deluxe pack (Integrated fridge freezer, Integrated microwave, Arms to sofa, and Freestanding dining chairs)



Features at a glance

	Margaux	Bordeaux	Morlaix	Burgundy	Provence	Loire	Royan
Exterior							
Fusion chassis with galvanised finish warrantied for 10 years	✓	✓	✓	✓	✓	✓	✓
Bonded sandwich exterior wall construction	✓	✓	✓	✓	✓	✓	✓
Coated steel pantile roof	✓	✓	✓	✓	✓	✓	✓
Distinctive folded steel bargeboards with lighting	✓	✓	✓	✓	✓	✓	✓
Bay window	✗	✗	✗	✗	✓	✓	✓
Woodgrain textured aluminium cladding	✓	✓	✓	✓	✓	✓	✓
Front aspect sliding doors	O	O	O	O	O	✗	✗
Full height front aspect fixed window	✓	✓	✓	✓	✓	✗	✗
uPVC windows with push-button security locks	✓	✓	✓	✓	✓	✓	✓
PVC gutters and down pipes	✓	✓	✓	✓	✓	✓	✓
Low energy exterior light	✓	✓	✓	✓	✓	✓	✓
Environmental exterior	O	O	O	O	O	O	O
Brown exterior	O	O	O	O	O	O	O
Anthracite window frames	✓	✓	✓	✓	✓	✓	O
Insulation							
Thermaglas uPVC double glazing	✓	✓	✓	✓	✓	✓	✗
Insulation thickness in floor (mm)	80	60	80	80	60	60	60
Insulation thickness in roof (mm)	100	100	100	100	100	100	100
Insulation thickness in walls (mm)	60	30	60	60	30	30	30
Lagged underfloor pipes	✓	✓	✓	✓	✓	✓	✓
Interior							
Smart Command System	O	O	O	O	O	O	O
Condensing gas combi-boiler central heating and hot water system (GCH)	✓	✓	✓	✓	✓	✓	✓
Luxury carpet with underlay throughout to bedroom and lounge	✓	✓	✓	✓	✓	✓	✓
Hardwearing vinyl flooring in uncarpeted rooms	✓	✓	✓	✓	✓	✓	✓
Low energy LED lighting throughout	✓	✓	✓	✓	✓	✓	✓
USB (A&C) sockets	✓	✓	✓	✓	✓	✓	✓
Woodgrain	THO	NO	THO	NO	NO	TO	TO
Lounge							
Freestanding sofas with scatter cushions	✓	✓	✗	✗	✓	✗	✗
Fixed sofas with scatter cushions	✗	✗	✓	✓	✗	✓	✓
Pull-out sofa bed mechanism	✓	✓	✓	✓	✓	✓	O
Coffee table	✗	✓	✓	✓	✓	✓	✓
Footstool(s) for coffee table	✗	✓	O	O	✓	O	O
Ottoman footstool	✓	✗	✗	✗	✗	✗	✗
Contemporary electric fire	O	O	✗	✗	✓	✗	✗
Bluetooth audio connection to lounge ceiling speaker	O	O	O	O	O	O	O
Framed wall pictures	✓	✓	✗	✗	✓	✗	✗
Kitchen / Dining							
Glass fronted oven and grill with electronic ignition	✓	✓	✓	✓	✓	✓	✓
Cooker hood with extractor vented to outside	✓	✓	✓	✓	✓	✓	✓
4-burner gas hob with electronic ignition	✓	✓	✓	✓	✓	✓	✓
Integrated fridge and freezer	✓	✓	✓	✓	✓	✓	O <sup>1</sup>
Microwave oven	✓	✓	✓	✓	✓	✓	O <sup>1</sup>
12 place dishwasher / 10 place slimline dishwasher	O	O	O	O	✗	O	✗
Sink and drainer	✓	✓	✓	✓	✓	✓	✓
Laminate worktops with matching upstands	✓	✓	✓	✓	✓	✓	✓
Soft-closing drawers	✓	✓	✓	✓	✓	✓	✗
Fixed dinette	✗	✗	✓	✗	✗	✓	✓
Freestanding dining suite	✓	✓	✗	✓	✓	O	✓
Washroom(s)							
Shower cubicle with thermostatic shower	✓	✓	✓	✓	✓	✓	✓
Dual flush WC	✓	✓	✓	✓	✓	✓	✓
Extractor fan in main washroom	✓	✓	✓	✓	✓	✓	O
Towel radiator in shower rooms	✓	✓	✓	✓	✓	✓	✗
Radiator in en-suite	✓	✓	✓	✓	✓	✓	✓
LED vanity lighting	✓	✓	✓	✓	✓	✓	✓
Shower cubicle topper (model dependant)	✓	✓	✓	✓	✓	✓	✗
Shaver socket in main washroom	✓	✓	✓	✓	✓	✓	O
Bedrooms							
Lift-up bed allowing easy access to storage area (main bedroom)	✓	✓	O	O	✓	O	O
One bed stores under the other for extra space in one twin bedroom	O	O	O	O	✓	✓	O
Duvalay™ Crib 5 mattress	✓	✓	✓	✓	✓	✓	✓
Padded headboard(s)	✓	✓	✓	✓	✓	✓	✗
Reading lights	✓	✗	✗	✗	✗	✗	✗
TV sockets & Co-Ax plus booster	✓	✓	✓	✓	✓	✓ <sup>2</sup>	O <sup>3</sup>
Safety							
Mains linked Smoke and Heat alarms	✓	✓	✓	✓	✓	✓	✓
5-year carbon monoxide detectors	✓	✓	✓	✓	✓	✓	✓
Fire extinguisher	✓	✓	✓	✓	✓	✓	✓
Fire blanket	✓	✓	✓	✓	✓	✓	✓

1. Freestanding or integrated

✓ Standard

E/S En-suite
2. Except 29ft models

✗ Not available

THO Tobacco Halifax Oak
3. Option for Main bedroom

O Option

TO Tisano Oak
- NA Navara Ash

NO Nebraska Oak

Dimensions & bed sizes

	Length <sup>#</sup>	Width <sup>#</sup>	Height <sup>#</sup>	Sleeps	Main Bed	Twin Beds	Rear Twin Beds	Sofa Bed
Royan								
28x12-2B	8.63m (28'4")	3.70m (12'2")	3.45m (11'4")	4 (Plus 2)	✓	✗		O
35x12-2B	10.93m (35'10")	3.70m (12'2")	3.45m (11'4")	4 (Plus 2)	✓	✗		O
35x12-3B	10.93m (35'10")	3.70m (12'2")	3.45m (11'4")	6 (Plus 2)	✓	✗	✓	O
Loire								
28x10-2B	8.63m (28'4")	3.05m (10'0")	3.29m (10'10")	4 (Plus 2)	✓	✗		✓
28x12-2B	9.77m (32'1")	3.70m (12'2")	3.41m (11'2")	4 (Plus 2)	✓	✗		✓
32x10-2B	8.63m (28'4")	3.05m (10'0")	3.29m (10'10")	4 (Plus 2)	✓	✗		✓
32x12-2B	9.77m (32'1")	3.70m (12'2")	3.41m (11'2")	4 (Plus 2)	✓	✗		✓
35x12-2B	10.93m (35'10")	3.70m (12'2")	3.41m (11'2")	4 (Plus 2)	✓	✗		✓
35x12-3B	10.93m (35'10")	3.70m (12'2")	3.41m (11'2")	6 (Plus 2)	✓	✗	✓	✓
38x12-2B	11.73m (38'6")*	3.70m (12'2")	3.41m (11'2")	4 (Plus 2)	✓	✗		✓
38x12-3B	11.73m (38'6")	3.70m (12'2")	3.41m (11'2")	6 (Plus 2)	✓	✗	✓	✓
Provence								
35x12-2B Bay	10.94m (35'11")	3.70m (12'2")	3.39m (11'1")	4 (Plus 2)	✓	✗		✓
35x12-2B Outlook	10.94m (35'11")	3.70m (12'2")	3.39m (11'1")	4 (Plus 2)	✓	✗		✓
38x12-2B Bay	11.73m (38'6")*	3.70m (12'2")	3.39m (11'1")	4 (Plus 2)	✓	✗		✓
38x12-2B Outlook	11.73m (38'6")	3.70m (12'2")	3.39m (11'1")	4 (Plus 2)	✓	✗		✓
39x12-3B Bay	11.86m (38'11")*	3.70m (12'2")	3.39m (11'1")	6 (Plus 2)	✓	✗	✓	✓
39x12-3B Outlook	11.86m (38'11")	3.70m (12'2")	3.39m (11'1")	6 (Plus 2)	✓	✗	✓	✓
Burgundy								
29x12-2B	8.78m (28'10")*	3.76m (12'4")	3.60m (11'10")	4 (Plus 2)	✓	✗		✓
32x12-2B	9.85m (32'4")	3.76m (12'4")	3.60m (11'10")	4 (Plus 2)	✓	✗		✓
36x12-2B	11.04m (36'3")	3.76m (12'4")	3.60m (11'10")	4 (Plus 2)	✓	✗		✓
36x12-3B	11.04m (36'3")	3.76m (12'4")	3.60m (11'10")	6 (Plus 2)	✓	✗	✓	✓
38x12-2B	11.80m (38'8")	3.76m (12'4")	3.60m (11'10")	4 (Plus 2)	✓	✗		✓
39x12-3B	11.80m (38'8")*	3.76m (12'4")	3.60m (11'10")	6 (Plus 2)	✓	✗	✓	✓
Morlaix								
36x12-2B	10.89m (35'9")	3.76m (12'4")	3.60m (11'10")	4 (Plus 2)	✓	✗		✓
38x12-2B	11.80m (38'8")	3.76m (12'4")	3.60m (11'10")	4 (Plus 2)	✓	✗		✓
40x12-3B	12.19m (40'0")	3.76m (12'4")	3.60m (11'10")	6 (Plus 2)	✓	✗	✓	✓
Bordeaux								
33x12-2B	10.09m (33'1")	3.70m (12'2")	3.60m (11'10")	4 (Plus 2)	✓	✗		✓
35x12-2B	10.93m (35'10")	3.70m (12'2")	3.60m (11'10")	4 (Plus 2)	✓	✗		✓
38x12-2B	11.75m (38'7")	3.70m (12'2")	3.60m (11'10")	4 (Plus 2)	✓	✗		✓
38x12-3B	11.75m (38'7")	3.70m (12'2")	3.60m (11'10")	6 (Plus 2)	✓	✗	✓	✓
38x12-2B Escape	10.09m (33'1")	3.70m (12'2")	3.60m (11'10")	4 (Plus 2)	✓	✗		✓
41x12-3B Escape	10.93m (35'10")	3.70m (12'2")	3.60m (11'10")	6 (Plus 2)	✓	✗	✓	✓
Margaux								
35x12-2B	10.99m (36'1")	3.76m (12'4")	3.60m (11'10")	4 (Plus 2)	✓	✗		✓
38x12-2B	11.80m (38'8")	3.76m (12'4")	3.60m (11'10")	4 (Plus 2)	✓	✗		✓
38x12-2B ES	11.80m (38'8")	3.76m (12'4")	3.60m (11'10")	4 (Plus 2)	✓	✗		✓
38x12-3B	11.80m (38'8")	3.76m (12'4")	3.60m (11'10")	6 (Plus 2)	✓	✗	✓	✓
39x12-3B ES	11.80m (38'8")	3.76m (12'4")	3.60m (11'10")	6 (Plus 2)	✓	✗	✓	✓

- ✓ 1.91m x 1.53m (6'3" x 5'0")

✓ 1.91m x 1.37m (6'3" x 4'6")
- ✗ 1.83m x 0.69m (6'0" x 2'3")

✗ 1.83m x 0.61m (6'0" x 2'0")

✓ 1.80m x 1.12m (5'11" x 3'8")
- ✓ 1.76m x 0.69m (5'9" x 2'3")

✓ 1.76m x 1.61m (5'9" x 2'0")

\* Estimate  
# Length = Overall body length at floor level  
# Width = Width at floor level  
# Height = Overall height  
O = Optional



# Discover our optional Eco extras

At Swift, we're committed to creating holiday homes that are not only stylish and comfortable, but also kinder to the planet. Across all Swift holiday homes, you can upgrade with a range of innovative eco technologies that support more sustainable living - without compromising convenience or luxury.



## Smart Comfort

Control your heating remotely with Smart Command. Pre-warm your holiday home or adjust the temperature on the go, all from your smart device.



## All-Electric Heating

A clean and efficient fully electric boiler and wet central heating system, eliminating the need for gas bottles.



## Smarter Water Heating

Using energy harvested through solar panels, the SunAmp water heater allows heat to be stored compactly and released gradually, even when the heat source is off. This stored energy can then heat water for over an hour when fully charged.

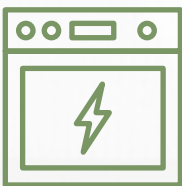

## All-Electric Cooking

Modern, efficient and sustainable, our induction hobs and electric ovens reduce the need for gas bottles.



## Solar Energy

Our Swift roof structures have the option to be solar ready, offering a renewable energy boost to reduce your reliance on the grid and lower your carbon footprint even further.



Scan the QR code to learn more about our Eco options

# Introducing Smart Command

New for 2026, the Smart Command system is as an optional extra available across all Swift holiday home ranges. This eco-friendly system puts you in control of your onboard systems via a touchscreen panel and smartphone app. Use Bluetooth when nearby or your internet connection remotely to monitor power, temperature, humidity, and your holiday home's location. You can even control the heating for a warm welcome on colder days.



## Heating

Activate whilst out exploring and enjoy the warmth when you get back. Forgot to turn your heating off when you left? no problem - just log into the app.



## Controls

Control switch appliances such as lighting and heating with timers.



## Energy

See overviews of live energy generation and usage.



## Enviro

See information on external and internal temperatures as well as internal humidity levels



Scan the QR code to learn more about Smart Command.

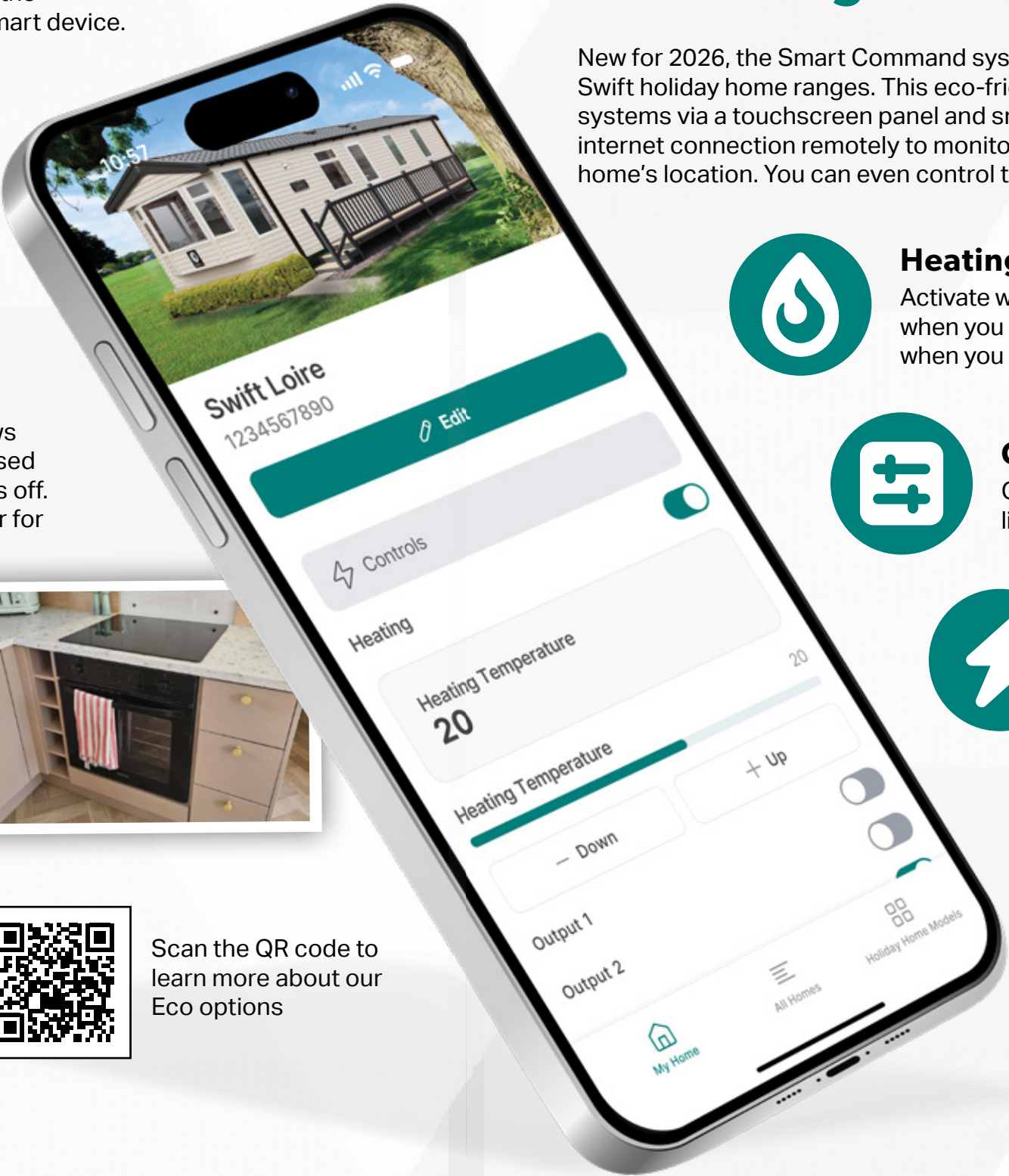



# Exterior finishes

Swift holiday homes are designed for long-lasting great looks. The exterior is woodgrain textured aluminium cladding. Anthracite glazing is part of the option for colour aluminum and an option for Sandy Beige.

Woodgrain Textured Aluminium	Standard Sandy Beige	Optional Environmental Green	Optional Brown
All Swift holiday home ranges	✓	✓	✓

SANDY BEIGE



ENVIRONMENTAL GREEN



BROWN



# Only Swift approved partners sell approved Swift holiday homes and lodges

Swift wants to make sure your buying experience is the best it can be. When you buy from a Swift Approved Partner, you can rest assured that your holiday home is fully supported by Swift Group and the supplying distributor.

The benefits of buying from a Swift Approved Partner include:

- Swift Group Approved Warranty
- Dealer access to Swift Connect aftersales support
- Approved spare parts
- Approved engineers
- Access to Swift Approved technical engineers
- Product on display at distributors
- Financial services to help with your purchase\*

Find your nearest Swift Approved Partner from our list on the back of the brochure or the Swift Holiday Homes website, [swiftholidayhomes.co.uk](http://swiftholidayhomes.co.uk), and look out for the Swift Approved Partner signs in dealerships.

\* Subject to status







# SWIFT

## Swift Distribution Partners

### Cumbria

**Kendal Caravans**  
Kendal - Lake District  
Tel: 01539 823659  
kendalcaravans.co.uk

### Devon

**Surf Bay Leisure**  
Winkleigh  
Tel: 01837 680100  
surfbayleisure.co.uk

### Durham

**Ideal Caravans**  
Durham  
Tel: 0191 378 0146  
idealcaravans.co.uk

### Essex

**UK Caravan Centre**  
Billericay  
Tel: 0800 246 1206  
ukcaravancentre.co.uk

### Hampshire

**PM Leisure**  
Hayling Island  
Tel: 023 9246 7722  
pmleisure.co.uk

### Lancashire

**Kendal Caravans**  
Blackpool  
Tel: 01253 301505  
kendalcaravans.co.uk

### Lincolnshire

**Seymours Caravans**  
Skegness  
Tel: 01754 764270  
seymourscaravans.co.uk

### TLC Skegness

**Skegness**  
Tel: 01754 875050  
theleisurecompany.co.uk

### Norfolk

**McDonnell Caravans**  
Kings Lynn  
Tel: 01553 636243  
mcdonnellcaravans.co.uk

**Pioneer Caravans**  
Peterborough  
Tel: 01733 222244  
pioneer-caravans.co.uk

### Northumberland

**Ideal Caravans**  
Adderstone  
Tel: 0191 378 6615  
idealcaravans.co.uk

### Shropshire

**Salop Leisure Ltd**  
Shrewsbury  
Tel: 01743 282400  
salopleisure.co.uk

### Somerset

**Surf Bay Leisure**  
Bream  
Tel: 01278 751171  
surfbayleisure.co.uk

### Worcestershire

**Salop Leisure**  
Stourport-on-Severn  
Tel: 01299 878872  
salopleisure.co.uk

### Yorkshire

**Bridlington**  
Caravan Centre  
Bridlington  
Tel: 01262 606777  
bridlingtoncaravans.com

**The Swift Show Park**  
Cottingham  
Tel: 01482 847332  
swiftholidayhomes.co.uk

**Yorkshire Holiday**  
Homes  
Wetherby  
Tel: 01937 849128  
yorkshirehh.co.uk

### Ireland

**Harry Farrell & Sons Ltd**  
Dublin  
Tel: +353 1 4589410  
harryfarrellsons.ie

### Wallace Mobile Homes

**Co Wexford**  
Tel: +353 51 511435  
wallacemobilehomes.com

**Kenneally Holiday**  
Homes  
Co Cork  
Tel: +353 21 4542478  
kenneallyholidayhomes.ie

**Clancys Mobile Homes**  
Co Limerick  
Tel: 353 85 8582793  
clancysmobilehomes.ie

### Northern Ireland

**Sandycove Holiday**  
Homes  
Newtownards  
Tel: 028 4275 8200  
sandycove.co.uk

**Hayes Caravans**  
Dungannon  
Tel: 0288 7767575  
hayescaravans.com

### Scotland

**Swalwell Holiday Group**  
Gatehouse of Fleet  
Tel: 01556 506 200  
swalwellholidaygroup.co.uk

### Dee Valley Caravans

**Aberdeen**  
Tel: 01330 811351  
deevalleycaravans.co.uk

### Wales

**Blackhills Caravan**  
Sales  
Gower  
Tel: 01792 851221  
blackhillscaravansales.co.uk

**Lloyds Caravan &**  
Lodge Sales  
Towyn  
Tel: 01745 832050  
lloyds-caravans.co.uk

**Salop Leisure**  
Machynlleth  
Tel: 01654 705900  
salopleisure.co.uk

**Mon Caravans**  
Anglesey  
Tel: 01248 711070  
moncaravans.com

### Blackhills Caravan

**Sales**  
Tenby  
Tel: 01834 818840  
blackhillscaravansales.co.uk

### Belgium

**Caravancentrum Roels**  
Tel: +32 (0)9 369 20 26  
caravancentrumroels.be

### Germany

**De-Bergjes**  
info@bergjes-ostsee.de  
+49 (0) 4533 78 54947

### Holland

**De-Bergjes**  
+31 (0)475 495 079  
info@bergjes.nl

  
THE SWIFT  
**SHOW PARK**

Our Show parks  
(shown in yellow)  
have a wide range  
of current Swift  
holiday homes on  
display at all times.

## Visit [swiftholidayhomes.co.uk](http://swiftholidayhomes.co.uk)

This brochure does not constitute an offer by Swift Group Limited (Swift). Swift reserves the right to alter specifications and prices at any time as materials and conditions demand. Distributors and dealers sell Swift products on their own account and not as agents of Swift. Accordingly, they have no authority to bind Swift or to make any representation or undertaking whatsoever on behalf of Swift. Please note, within this brochure, concept imagery may be used and therefore final specifications may be subject to change. Please confirm with your supplying dealer. All props are for photographic purposes only and are not included in the specification. Models shown may be fitted with optional extras. Issued September 2025.

 **MANUFACTURED  
IN BRITAIN**