



SWIFT
CREATING SMILES FOR LIFE

Love
Holiday
Homes



Love life
LOVE SWIFT

2022 HOLIDAY HOME RANGE

UNDER OUR OWN BLUE SKY

Take me to a place that I call Here,
Hold me in a time that I call This
The air is clean, the light is clear
And now an outdoor kind of bliss
Draws me to a spot I really love;
The door wide open, the kettle on,
A family that fits me like a glove.

A moment's pause for those who've gone
Who still remain in the mind and heart.

And now, under our very own blue sky
The rest of our lives can slowly start
And our spirits can begin to fly
With memories of where we've been,
Those mornings we have yet to know
Those brand new vistas all unseen.
Love life, I say. And now, let's go!

©Ian McMillan 2021

love life
LOVE SWIFT



HOLIDAY HOME RANGE

At Swift we want your holiday home to be your sanctuary, your protective bubble where you can relax, unwind and let everything else melt away. That's why everything we produce is designed for the utmost luxury and practicality, using our innovative approach to help you create smiles for life. Join us for a tour of the collection...

CONTENTS

- 04 SWIFT SUPERIOR STANDARD
- 06 VENDEE
- 10 ANTIBES
- 14 MOSELLE
- 18 BORDEAUX / BORDEAUX ESCAPE
- 22 BURGUNDY
- 26 LOIRE
- 30 ARDENNES
- 34 HOLIDAY HOMES AT A GLANCE
- 36 THE SWIFT DIFFERENCE
- 38 HOLIDAY HOME DIMENSIONS
- 40 FINISHES AND SOFT FURNISHINGS



SWIFT SUPERIOR STANDARD

There's no better feeling than stepping into your holiday home for a relaxing getaway, so we do everything possible to make that feeling last for years to come.

We pride ourselves on applying superior manufacturing quality to everything we produce, giving you the confidence that your investment is protected and built to last. With the comfort of total assurance in your purchase, you can get on with the important things in life - making smiles and enjoying unforgettable getaways.

And prioritising your peace of mind, we offer outstanding warranties, including a 3-year Manufacturer Supersure Warranty, 5-year Structural Warranty and 10-year Chassis Warranty.



EXCLUSIVE DUVALAY™ MATTRESSES
All beds feature indulgent Duvalay™ mattresses for the best nights' sleep possible



STAIN RESISTANT CARPETS
With stain resistant carpets, there's no need to waste your precious holiday time scrubbing



BONDED EXTERIOR WALLS
'Sandwich' construction walls provide a more rigid exterior, bonded with insulation in the middle



FULLY GALVANISED CHASSIS
A fully galvanised chassis, warrantied for 10 years



ELECTRICAL AND USB SOCKETS
Stay connected with electrical and USB sockets in selected areas keeping everything charged



HIGH THERMAL EFFICIENCY
Enjoy outstanding thermal efficiency, proven by environmental chamber testing and calculations

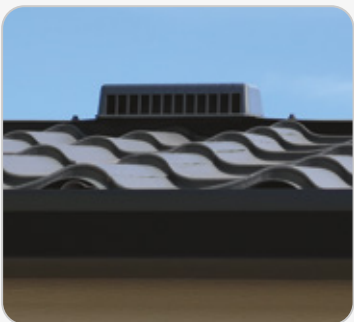

EXTERNALLY VENTED EXTRACTORS
Keep your holiday home fresh and dry with externally vented extractors, preventing damp and odours



INTEGRATED MICROWAVES
Optimising valuable work surface space, all Swift holiday homes feature integrated microwaves



INTEGRATED FRIDGE FREEZERS
Integrated fridge freezers are included across all ranges to maintain a sleek, uncluttered look (except 10ft-wide models)



LED CEILING LIGHTS
Benefitting the environment and your pocket, bright, low energy LED lighting is included throughout







Step inside Vendee, Swift's cosy country retreat and one of our most popular Holiday Homes. With its contemporary cottage feel, this premium holiday home is refreshed for 2022 with the **NEW** Acanthium soft furnishings, enhancing the range's on-trend interiors. Enjoy the finer things in life with Vendee's luxurious details, ample space and plentiful storage.

Model size	Bedrooms	Main bed	Twin beds
40' x 12'	2	2.02m x 1.53m (6'8" x 5'0")	1.90m x 0.75m (6'3" x 2'6")

VENDEE FEATURES

Along with the Swift Superior Standard (see page 4), Vendee also comes with many desirable extras including:

- 

Double Glazing
- 

Central Heating Boiler
- 

Cooker
- 

Electric Fire
- 

Wardrobe
- 

TV Point



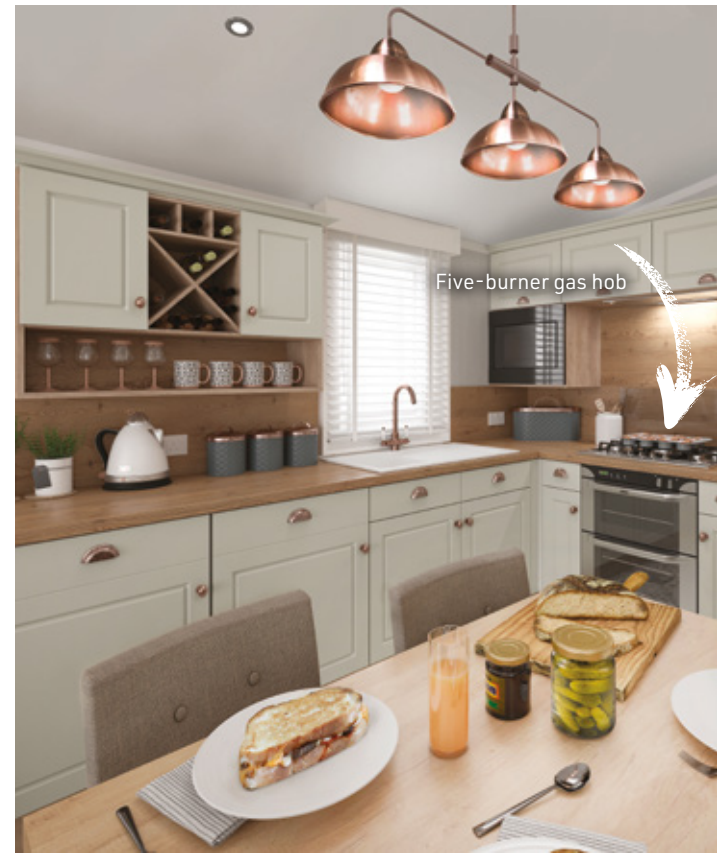



FEATURES

EXTERIOR

- Fusion galvanised chassis with finish warrantied for ten years
- Bonded sandwich exterior wall construction for greater strength
- Coated steel pantile roof
- Distinctive pre-coated 'folded' steel bargeboards with LED lighting to front aspect
- Woodgrain textured Sandy Beige aluminium cladding
- Front aspect French doors
- Anthracite uPVC windows with push-button security locks
- PVC gutters and down pipes
- Low energy exterior side lighting

INSULATION

- Excellent thermal performance:
 - Thermaglas uPVC double glazed windows & doors
 - 50mm insulation in floor
 - 90mm insulation in roof
 - 30mm insulation in walls
 - Lagged underfloor pipes

INTERIOR

- 7ft (2.13m) high ceilings at side walls
- **NEW** 'Acanthium' soft furnishing scheme
- Luxury carpet with underlay
- Hardwearing vinyl flooring in Almeria in kitchen/dining/bathroom(s)
- Nebraska Oak woodgrain
- Condensing gas combi-boiler central heating and hot water system with radiator thermostat
- Low energy LED lighting
- USB sockets
- Double electric sockets throughout

ENTRANCE HALLWAY

- Seat bench featuring coat hooks and shoe storage
- Large mirror and wall unit

LOUNGE

- Freestanding two-seater and three-seater sofas with scatter cushions
- Complementary footstool with storage
- TV unit with storage, TV provision and Sky TV cable for connection only to TV cabinet
- Additional high level TV point
- Contemporary 2kW electric Optiflame® stove feature fire with mirror over fireplace
- Central Tyler copper effect pendant light feature
- White slatted wooden blinds
- Full height luxury curtains to front aspect
- Contemporary framed colour wall pictures

KITCHEN / DINING

- Belling stainless steel oven
- Five-burner gas hob with central wok burner and electronic ignition
- Integrated externally vented silver extractor hood
- Integrated microwave oven (800w)*
- Integrated fridge and freezer
- Kitchen with country classic feel. Cupboards in Dakar with Larch woodgrain details and copper cup door and drawer handles
- Soft close drawers
- 40mm Brown Mountain Larch laminate worktops
- White resin bowl and drainer with copper effect tap
- Brown Mountain Larch splashbacks
- Integrated wine rack
- Florence dining table in Nebraska Oak/Painted Porcelain with four Combo chairs

BATHROOM(S)

- Shower cubicle with thermostatic shower, topper and LED downlights
- Dual flush WC with soft close toilet seat
- White heated towel rails
- Vanity storage unit with mirror above
- Additional storage cupboard
- Extractor fan in main bathroom and en suite

BEDROOMS

- King-size double bed in main bedroom with lift up storage
- Duvalay™ mattress to all beds with Crib 5 rated fabric
- Padded headboard in main bedroom
- Ample storage with bedside units and over bed cupboards in the main bedroom
- Wall mounted bedside lights
- Dressing table with mirror, lighting and storage
- Window seat and TV panel with credenza drawer unit in main bedroom
- Nature inspired wall pictures
- TV sockets and Co-Ax to all bedrooms plus booster

OPTIONS

- Dishwasher or washing machine
- Freestanding three-seater sofa with fold out occasional bed, replacing standard three-seater sofa
- Environmental exterior with anthracite grey window frames
- Wireless programmable room thermostat
- Bluetooth® audio connection to lounge ceiling speakers
- Shaving socket in main bathroom
- SwiftShield stain-resistant fabric

FLOORPLANS



40' x 12' - 2 Bedroom

*The model fitted may differ from that shown in images, please check with supplying dealer or park



Bright, sophisticated and packed with superb features, Antibes is designed for family life. From the moment you step through the front door, you'll find an airy open-plan living area which blends modern design with a relaxing ambiance, creating a holiday home you'll look forward to visiting year after year.

ANTIBES FEATURES

Along with the Swift Superior Standard (see page 4), Antibes also comes with many desirable extras including:

Model size	Bedrooms	Main bed	Twin beds	Rear twin beds	Sofa bed
39' x 12'	2	1.91m x 1.53m (6'3" x 5'0")	1.83m x 0.69m (6'0" x 2'3")	N/A	1.80m x 1.12m (5'11" x 3'8")
40' x 12'	3	1.91m x 1.37m (6'3" x 4'6")	1.83m x 0.69m (6'0" x 2'3")	1.83m x 0.69m (6'0" x 2'3")	1.80m x 1.12m (5'11" x 3'8")



Sofa Bed



TV Point



Cooker



Wardrobe







FEATURES

EXTERIOR

- Fusion galvanised chassis with finish warrantied for ten years
- Bonded sandwich exterior wall construction for greater strength
- Coated steel pantile roof
- Distinctive pre-coated 'folded' steel bargeboards with LED lighting to front aspect
- Architectural front design
- Sandy Beige woodgrain textured aluminium cladding
- Anthracite uPVC windows with push-button security locks
- PVC gutters and down pipes
- Low energy exterior light

INSULATION

- Excellent thermal performance:
 - 50mm insulation in floor
 - 90mm insulation in roof
 - 30mm insulation in walls
 - Lagged underfloor pipes

INTERIOR

- 7ft (2.13m) high ceilings at side walls
- Ibiza soft furnishings
- Luxury carpet with underlay
- Laminate effect vinyl flooring in kitchen/dining/ bathroom(s)
- Tisano Oak woodgrain
- Modern planked ceiling system
- Low energy LED lighting throughout
- Curtains and voiles throughout
- USB sockets
- Double electric sockets throughout

LOUNGE

- Freestanding L-shaped sofa with fold out occasional bed and scatter cushions
- TV area with feature wall, provision for flat screen TV (up to 40') and Sky TV cable for connection only, LED lighting and storage
- Decorative feature wall behind TV space
- Bookshelf between lounge and dinette
- Two cube stools stored under coffee table
- Wall mirror
- Framed wall picture

KITCHEN / DINING

- Thetford Cocina glass fronted oven, grill and electronic ignition with improved door function, higher temperatures, burner rating and heat-up times
- Four-burner gas hob with electronic ignition
- Black glass oven splashback/heat shield
- Black designer angled glass cooker hood with externally vented extractor fan
- Integrated microwave oven (800w)*
- Integrated fridge and freezer
- Streamlined kitchen units with handleless doors
- Soft close drawers
- 40mm laminate worktops with matching upstands
- Under cupboard worktop feature lighting
- 1½ bowl stainless steel sink/drainer
- Stylish wood finish dining table with bench and two chairs
- Double width window with roller blinds

BATHROOM(S)

- Windermere shower cubicle with thermostatic shower, ceramic tiled feature and LED downlight in main bathroom and en suite in 39' x 12'
- Dual flush WC with soft close toilet seat
- Extractor fan in bathroom and en suite in 39' x 12'
- Ocean Drive feature panel over vanity with LED lighting

BEDROOMS

- King-size double bed in main bedroom with lift up storage (4'6" in 3 bed models) and feature panel above headboard
- **NEW** deeper and more luxurious Aurora Duvalay™ mattress to all beds with Crib 5 rated fabric
- Padded headboard(s)
- Reading lights
- Ample storage with bedside units and over bed lockers with LED feature lighting
- Vanity area with LED illuminated mirror and socket
- Loft style feature panel in twin bedroom(s)
- TV sockets & Co-Ax to all bedrooms plus booster

OPTIONS

- Environmental exterior with anthracite grey window frames (only available with double glazing)
- Sliding front aspect patio doors
- Thermaglas uPVC double glazing with anthracite window frames
- Condensing gas combi-boiler central heating and hot water system:
 - Radiator thermostats
 - White towel radiator in shower rooms
- Wireless programmable room thermostat with gas central heating
- Integrated dishwasher or washing machine
- Bluetooth® audio connection to lounge ceiling speakers
- **NEW** twin room USB sockets
- Shaving socket in bathroom
- SwiftShield stain resistant fabric

FLOORPLANS



39' x 12' - 2 Bedroom

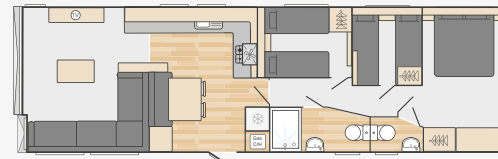

40' x 12' - 3 Bedroom

*The model fitted may differ from that shown in images, please check with supplying dealer or park



'Scandinavian' interior scheme

Moselle Holiday Home is ready to impress with our first customisable front lounge - guaranteeing you the best view from your sofa. Designed with togetherness in mind, Moselle provides a welcoming space for your family retreats, including the open-plan kitchen-diner which creates a cosy, intimate space for sociable family time. Offering a choice of two interior design schemes, Moselle promises an escape to the country with calming vibes or an escape to Scandinavia with its bold on-trend design featuring 'pops' of black.

Model size	Bedrooms	Main bed	Twin beds	Rear twin beds	Sofa bed
35' x 12'	2	1.91m x 1.53m (6'3" x 5'0")	1.90m x 0.75m (6'3" x 2'6")	N/A	N/A
38' x 12'	2	2.02m x 1.53m (6'8" x 5'0")	1.90m x 0.75m (6'3" x 2'6")	N/A	N/A
40' x 12'	3	1.91m x 1.37m (6'3" x 4'6")	1.83m x 0.75m (6'0" x 2'6")	1.83m x 0.75m (6'0" x 2'6")	N/A
			1.76m x 0.69m (5'9" x 2'3")	1.76m x 0.69m (5'9" x 2'3")	

MOSELLE FEATURES

Along with the Swift Superior Standard (see page 4), Moselle also comes with many desirable extras including:

- 
 TV Point
- 
 Cooker
- 
 Wardrobe
- 
 Configurable lounge







Large double wardrobe
and vanity area

Lift up under-bed storage

'Scandinavian' interior scheme

FEATURES

EXTERIOR

- Fusion galvanised chassis with finish warranted for 10 years
- Bonded sandwich exterior wall construction for greater strength
- Coated steel pantile roof
- Distinctive pre-coated 'folded' steel bargeboards with LED lighting to front aspect
- Sandy Beige woodgrain textured aluminium cladding
- Full height front aspect fixed window
- uPVC windows with push-button security locks
- PVC gutters and down pipes
- Low energy exterior side light

INSULATION

- Excellent thermal performance:
 - 50mm insulation in floor
 - 90mm insulation in roof
 - 30mm insulation in walls
 - Lagged underfloor pipes

INTERIOR

- Choice of two interior schemes - Scandinavian or Country Cottage
- 7ft (2.13m) side wall ceiling height
- Gas water heater
- Luxury carpet with underlay throughout lounge and bedrooms
- Tournai Stone effect vinyl flooring in kitchen/dining/main bathroom and Almeria Black flooring in en suite
- Modern Nebraska Oak woodgrain
- Cloakroom area with upholstered seat and shoe rack (except 3 bed model)
- Low energy LED lighting throughout
- USB sockets
- Double electric sockets throughout

LOUNGE

- Configurable lounge layout with TV points at both sides of lounge with Co-Ax and 240V socket
- Large freestanding sofa with footstool
- Freestanding armchair
- Freestanding TV station
- Oval coffee table
- Full width lined curtains to front aspect windows

KITCHEN / DINING

- Thetford Cocina glass fronted oven and grill with electronic ignition
- Four-burner gas hob with electronic ignition
- Built in cooker extractor vented to the outside
- Integrated black microwave
- Large hob glass splashback
- Full height integrated fridge freezer
- Nebraska Oak 40mm laminate worktops with matching upstands
- Cast resin sink bowl and drainer with tap
- Full height storage cupboard
- Modern open plan dining area with table, fixed seating and two stools

BATHROOM(S)

- Large shower cubicle with thermostatic shower and glass sliding door in main bathroom
- Second shower in en suite (38x12- 2 bed)
- Concealed dual flush WC in main bathroom
- Full-width Nebraska splashbacks to sinks
- LED vanity spotlights
- Extractor fan in all shower rooms

BEDROOMS

- King-size double bed in main bedroom with lift up storage (Double bed in 3 bed)
- Duvalay™ Aurora mattress to all beds with Crib 5 rated fabric, and featuring 'S-Line' pocket springs and a high-density foam layer for increased and lasting comfort
- Large double wardrobe and vanity area in main bedroom
- Bedside cabinets
- LED atmospheric lighting in main bedroom to curtain pelmets and wardrobe tops
- Wall lights in bedroom(s)
- TV sockets & Co-Ax to all bedrooms including booster
- USB points in all bedrooms

OPTIONS

- 'Thermaglas' uPVC double glazing
- Environmental exterior with anthracite grey window frames (only available with double glazing)
- Condensing gas combi-boiler central heating and hot water system:
 - Radiator thermostats
 - Radiator in en suite and towel radiator in shower rooms

- Front aspect French doors
- Integrated slim-line dishwasher
- Large freestanding sofa with fold-out occasional bed, replacing large standard sofa
- Wireless programmable room thermostat with gas central heating
- Bluetooth audio connection to lounge ceiling speakers
- Shaving socket in bathroom

SCANDINAVIAN INTERIOR DESIGN SCHEME	COTTAGE COUNTRY INTERIOR DESIGN SCHEME
FIKA soft furnishing scheme	Acanthium soft furnishing scheme
Wide Venetian blinds to lounge side window (including dinette)	Curtain to lounge side window (excluding dinette)
Kitchen with a modern Scandinavian feel, featuring Light Grey and Dust Grey kitchen doors with modern black door handles	Kitchen with country classic feel, featuring shaker style cupboards in Dakar Grey with brass cup drawer handles
Kitchen roller blind in Carnival Shadow	Kitchen roller blind in Carnival Papaya
Black cast resin sink bowl and drainer with matching black tap	White cast resin sink bowl and drainer with brass tap
Concrete effect dining table	Nebraska Oak Top Galway dining table with white frame
Main bedroom doors in Light Grey	Main bedroom doors in Dakar Grey
Aluminium wall lights in bedroom(s)	Brass reading and wall lights in bedroom(s)

FLOORPLANS



35' x 12' - 2 Bedroom

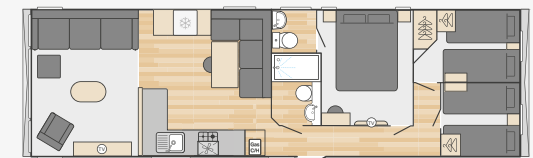

40' x 12' - 3 Bedroom



38' x 12' - 2 Bedroom

*The model fitted may differ from that shown in images, please check with supplying dealer or park



Bonded wall construction



Integrated 5ft deck with balustrade (Escape)

Well-appointed and stylish, Bordeaux is available in a choice of two or three bedrooms, offering contemporary accommodation for the whole family. The Bordeaux Escape model likewise enables sumptuous living, flowing through to an integrated veranda that's perfect for al fresco dining.

Model size	Bedrooms	Main bed	Twin beds	Rear twin beds	Sofa bed
33' x 12'	2	1.91m x 1.37m (6'3" x 4'6")	1.83m x 0.69m (6'0" x 2'3")	N/A	1.80m x 1.12m (5'11" x 3'8")
35' x 12'	2	1.91m x 1.53m (6'3" x 5'0")	1.83m x 0.69m (6'0" x 2'3")	N/A	1.80m x 1.12m (5'11" x 3'8")
38' x 12'	2	1.91m x 1.53m (6'3" x 5'0")	1.83m x 0.69m (6'0" x 2'3")	N/A	1.80m x 1.12m (5'11" x 3'8")
38' x 12' ES	2	1.91m x 1.53m (6'3" x 5'0")	1.83m x 0.69m (6'0" x 2'3")	N/A	1.80m x 1.12m (5'11" x 3'8")
38' x 12'	3	1.91m x 1.37m (6'3" x 4'6")	1.83m x 0.69m (6'0" x 2'3")	1.83m x 0.61m (6'0" x 2'0")	1.80m x 1.12m (5'11" x 3'8")
Bordeaux Escape					
38' x 12'	2	1.91m x 1.37m (6'3" x 4'6")	1.83m x 0.69m (6'0" x 2'3")	N/A	1.80m x 1.12m (5'11" x 3'8")
41' x 12'	3	1.91m x 1.37m (6'3" x 4'6")	1.83m x 0.69m (6'0" x 2'3")	1.83m x 0.61m (6'0" x 2'0")	1.80m x 1.12m (5'11" x 3'8")

BORDEAUX AND BORDEAUX ESCAPE FEATURES

Along with the Swift Superior Standard (see page 4), Bordeaux and Bordeaux Escape also come with many desirable extras including:



Sofa Bed



TV Point



Cooker



Wardrobe



Electric Fire

Image shown is the Bordeaux Escape lounge



Contemporary electric fire

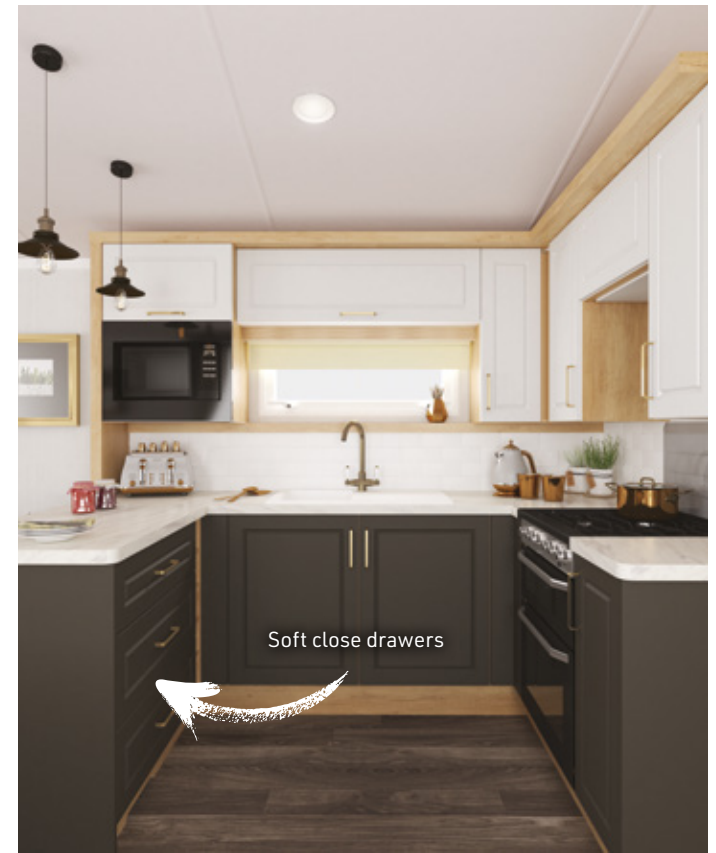

Soft close drawers



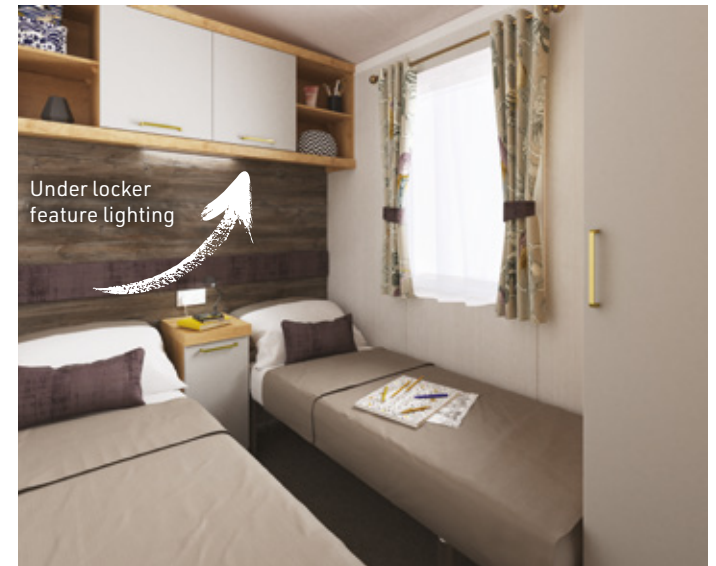

FEATURES

EXTERIOR

- Fusion galvanised chassis with finish warranted for ten years
- Bonded sandwich exterior wall construction for greater strength
- Coated steel pantile roof
- Distinctive pre-coated 'folded' steel bargeboards with LED lighting to front aspect
- Sandy Beige woodgrain textured aluminium cladding
- Covered integrated 5ft deck with balustrade (Bordeaux Escape)
- Front aspect sliding door (Bordeaux Escape)
- **NEW** large front aspect windows (Bordeaux)
- Rustic Oak uPVC windows with push-button security locks (Bordeaux Escape)
- White uPVC windows with push-button security locks (Bordeaux)
- PVC gutters and down pipes
- Low energy exterior side light

INSULATION

- Excellent thermal performance:
 - 50mm insulation in floor
 - 90mm insulation in roof
 - 30mm insulation in walls
 - Lagged underfloor pipes

INTERIOR

- 7ft (2.13m) high ceilings at side walls
- Sousel soft furnishing scheme
- Luxury carpet with underlay
- Laminate effect vinyl flooring in kitchen/dining/bathroom(s)
- Nebraska Oak woodgrain
- Modern planked interior ceiling system (Bordeaux Escape)
- Low energy LED lighting throughout
- Stylish Pronto Gold matt handles throughout
- USB sockets
- Electric sockets throughout

LOUNGE

- Freestanding two-piece suite with fold out occasional bed and scatter cushions
- **NEW** freestanding TV unit with drawer
- Additional wall mounted TV position suitable for 50" TV (in place of mirror)
- 2 x TV points with Co-Ax and 240V socket
- **NEW** Lounge wall unit with 2 doors and central shelf.
- Coffee table with two upholstered cylindrical stools underneath

- **NEW** larger mirror with gold frame with TV Socket behind for wall mounted TVs
- Framed wall picture

KITCHEN / DINING

- Thetford Cocina glass fronted oven, grill and electronic ignition with improved door function, higher temperatures, burner rating and heat-up times
- Four-burner gas hob with electronic ignition
- Discrete externally vented extractor fan
- Integrated microwave oven (800w)*
- Integrated fridge and freezer
- Stylish kitchen units with soft close doors and drawers in Riverstone Supermatt with upper doors in Light Grey perfect touch
- 40mm Levanto Marble laminate worktops with upstands
- Steam Punk pendant light fittings above central worktop
- Brass effect tap with porcelain handles and white resin bowl with drainer
- White tile effect splashback
- Dining table with Toulouse wood effect top
- Four Rochelle dining chairs in Riverstone (two additional folding chairs in three-bed models)
- Roller blind in Carnival Taupe

BATHROOM(S)

- Large shower cubicle with glass sliding door and thermostatic shower with topper in main bathroom
- Dual flush WC
- Acrylic splashback with green glass look
- LED vanity spotlights
- Extractor fan in main bathroom

BEDROOMS

- Double bed in main bedroom with lift up storage (king-size in 35'x12' 2B & 38' x12' 2B)
- Deep and luxurious Aurora Duvalay™ mattress to all beds with Crib 5 rated fabric, and featuring 'S-Line' pocket springs and a high-density foam layer for increased and lasting comfort
- Padded headboard(s)
- Bedside cabinets with Jackson Pine inset panel and overbed storage
- Under locker LED strip lights
- Vanity area with mirror and socket in main bedroom
- Brass effect curtain poles
- TV sockets & Co-Ax to all bedrooms plus booster
- **NEW** USB points in twin rooms

OPTIONS

- Thermaglas uPVC double glazing
- Gas combi-boiler central heating and hot water system;
 - Radiator thermostats and radiator in en-suite
 - Towel radiator in main bathroom
- Front aspect French doors (Bordeaux)
- Integrated slim-line dishwasher
- Environmental exterior with green window frames (only available with double glazing)
- Environmental exterior with anthracite grey window frames (only available with double glazing on Bordeaux)
- Wireless programmable room thermostat for gas central heating
- Bluetooth® audio connection to lounge ceiling speakers
- **NEW** twin room USB sockets
- Shaving socket in bathroom
- SwiftShield stain resistant fabric

*The model fitted may differ from that shown in images, please check with supplying dealer or park

FLOORPLANS

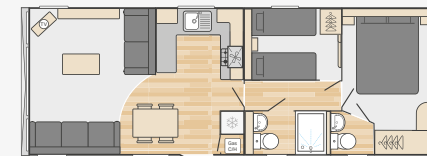

Bordeaux 33' x 12' - 2 Bedroom

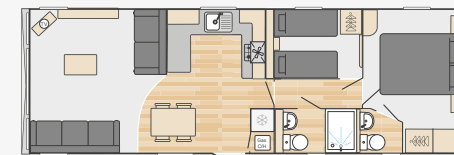

Bordeaux 35' x 12' - 2 Bedroom

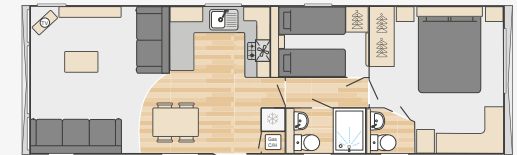

Bordeaux 38' x 12' - 2 Bedroom

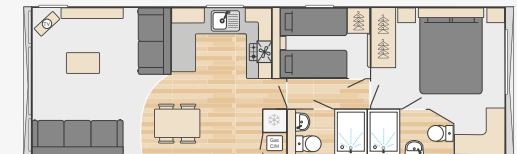

Bordeaux 38' x 12' - 2 Bedroom ES

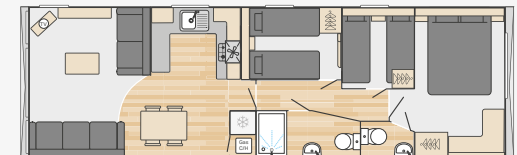

Bordeaux 38' x 12' - 3 Bedroom



Bordeaux Escape 38' x 12' - 2 Bedroom

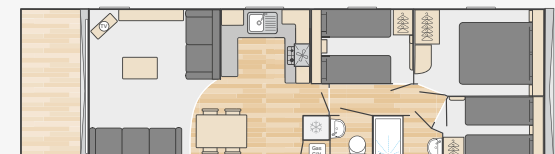

Bordeaux Escape 41' x 12' - 3 Bedroom

*The model fitted may differ from that shown in images, please check with supplying dealer or park



Burgundy offers outstanding value, fusing practicality with timeless design across a choice of two and three-bedroom layouts. Straightaway it's clear why Burgundy is one of Swift's most popular holiday homes, from the fresh 'Botanical' soft furnishings which use accents of nature to bring the outside in, to the sleek fixtures which lift the quality finish.

Model size	Bedrooms	Main bed	Twin beds	Rear twin beds	Sofa bed
29' x 12'	2	1.91m x 1.37m (6'3" x 4'6")	1.83m x 0.69m (6'0" x 2'3") 1.76m x 0.69m (5'9" x 2'3")	N/A	1.80m x 1.12m (5'11" x 3'8")
33' x 12'	2	1.91m x 1.37m (6'3" x 4'6")	1.83m x 0.69m (6'0" x 2'3") 1.76m x 0.69m (5'9" x 2'3")	N/A	1.80m x 1.12m (5'11" x 3'8")
36' x 12'	2	1.91m x 1.37m (6'3" x 4'6")	1.83m x 0.69m (6'0" x 2'3") 1.76m x 0.69m (5'9" x 2'3")	N/A	1.80m x 1.12m (5'11" x 3'8")
36' x 12'	3	1.91m x 1.37m (6'3" x 4'6")	1.83m x 0.69m (6'0" x 2'3") 1.76m x 0.69m (5'9" x 2'3")	1.83m x 0.61m (6'0" x 2'0")	1.80m x 1.12m (5'11" x 3'8")
38' x 12'	3	1.91m x 1.37m (6'3" x 4'6")	1.83m x 0.69m (6'0" x 2'3") 1.76m x 0.69m (5'9" x 2'3")	1.83m x 0.69m (6'0" x 2'3")	1.80m x 1.12m (5'11" x 3'8")

BURGUNDY FEATURES

Along with the Swift Superior Standard (see page 4), Burgundy comes with many desirable extras including:



Sofa Bed



TV Point



Cooker



Wardrobe



Electric Fire



Lined curtains with tie backs and voiles

Contemporary electric fire



Externally vented extractor fan





FEATURES

EXTERIOR

- Fusion galvanised chassis with finish warranted for ten years
- Bonded sandwich exterior wall construction for greater strength
- Coated steel pantile roof
- Distinctive pre-coated 'folded' steel bargeboards with LED lighting to front aspect
- Sandy Beige woodgrain textured aluminium cladding
- White uPVC windows with push-button security locks
- PVC gutters and down pipes
- Low energy exterior side light

INSULATION

- Excellent thermal performance:
 - 50mm insulation in floor
 - 90mm insulation in roof
 - 30mm insulation in walls
 - Lagged underfloor pipes

INTERIOR

- Botanical soft furnishing scheme
- Luxury carpet with underlay
- Laminate effect vinyl flooring in kitchen/dining/bathroom(s)
- Nebraksa Oak woodgrain
- Gas water heater
- Low energy LED lighting throughout
- USB sockets
- Double electric sockets throughout
- Hallway door on 36ft and 38ft models

LOUNGE

- Full length window
- Fixed L-shape sofa with fold out occasional bed
- Fireplace design with contemporary 2kW electric Optiflame® stove feature
- Lined curtains with tiebacks and voiles
- Coffee table
- Contemporary framed wall picture

KITCHEN / DINING

- Thetford Cocina glass fronted oven, grill and electronic ignition with improved door function, higher temperatures, burner rating and heat-up times
- Four-burner gas hob with electronic ignition
- Externally vented cooker hood
- Integrated microwave oven (800w)*
- Integrated fridge and freezer

- Shaker style kitchen doors in Matt Mussel with door knob handles and drawer cup pulls in Arial Pewter
- 40mm laminate worktops with matching upstands in Lava Grey Fleetwood finish
- Stainless steel sink/drainer
- Dining area with fixed style seating, freestanding table and two cylinder stools

BATHROOM(S)

- Shower cubicle with thermostatic shower in main bathroom
- Dual flush WC
- LED vanity spotlights
- Extractor fan in main bathroom

BEDROOMS

- **NEW** deeper and more luxurious Aurora Duvalay™ mattress to all beds with Crib 5 rated fabric
- Gazunda bed in one twin bedroom for extra space (one bed stores under the other when not required)
- Nebraksa Oak headboard(s)
- Bedside shelf units and overbed storage
- Vanity area with mirror and socket
- TV sockets & Co-Ax to all bedrooms plus booster (except 29' x 12' 2B)

OPTIONS

- Thermaglas uPVC double glazing
- Condensing gas combi-boiler central heating and hot water system:
 - Radiator thermostats
 - Radiator in en suite
- Front Aspect French doors (only on double glazed models)
- Environmental exterior with green window frames (only available with double glazing)
- Environmental exterior with anthracite grey window frames (only available with double glazing)
- Electric plinth heaters and towel rails
- Wireless programmable room thermostat for gas central heating
- Freestanding dining table and freestanding chairs
- Bluetooth® audio connection to lounge ceiling speakers
- **NEW** twin room USB sockets
- Shaving socket in bathroom
- SwiftShield stain resistant fabric

FLOORPLANS



29' x 12' - 2 Bedroom

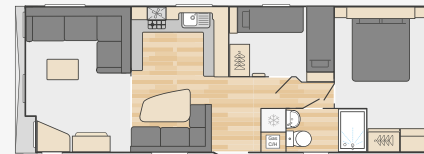

33' x 12' - 2 Bedroom

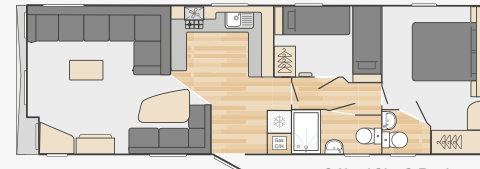

36' x 12' - 2 Bedroom

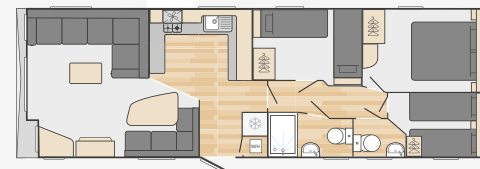

36' x 12' - 3 Bedroom

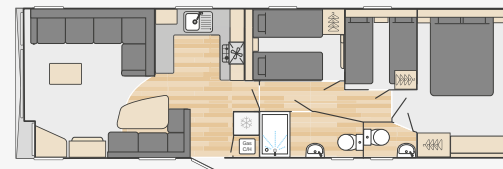

38' x 12' - 3 Bedroom

*The model fitted may differ from that shown in images, please check with supplying dealer or park



Bright, fun and functional, the coastal-inspired Loire delivers superb value in a choice of 10ft and 12ft-wide, two and three-bedroom models. Retaining the family-friendly accommodation, hardwearing materials and quality equipment, Loire now boasts a redesigned, nautical-inspired interior, alongside enhanced features.

Model size	Bedrooms	Main bed	Twin beds	Rear twin beds	Sofa bed
28' x 10'	2	1.91m x 1.37m (6'3" x 4'6")	1.83m x 0.61m (6'0" x 2'0") 1.76m x 0.61m (5'9" x 2'0")	N/A	1.80m x 1.12m (5'11" x 3'8")
28' x 12'	2	1.91m x 1.37m (6'3" x 4'6")	1.83m x 0.69m (6'0" x 2'3") 1.76m x 0.69m (5'9" x 2'3")	N/A	1.80m x 1.12m (5'11" x 3'8")
32' x 10'	2	1.91m x 1.37m (6'3" x 4'6")	1.83m x 0.69m (6'0" x 2'3") 1.76m x 0.69m (5'9" x 2'3")	N/A	1.80m x 1.12m (5'11" x 3'8")
32' x 12'	2	1.91m x 1.37m (6'3" x 4'6")	1.83m x 0.69m (6'0" x 2'3") 1.76m x 0.69m (5'9" x 2'3")	N/A	1.80m x 1.12m (5'11" x 3'8")
35' x 12'	2	1.91m x 1.37m (6'3" x 4'6")	1.83m x 0.69m (6'0" x 2'3") 1.76m x 0.69m (5'9" x 2'3")	N/A	1.80m x 1.12m (5'11" x 3'8")
35' x 12'	3	1.91m x 1.37m (6'3" x 4'6")	1.83m x 0.69m (6'0" x 2'3") 1.76m x 0.69m (5'9" x 2'3")	1.83m x 0.61m (6'0" x 2'0")	1.80m x 1.12m (5'11" x 3'8")
38' x 12'	3	1.91m x 1.37m (6'3" x 4'6")	1.83m x 0.69m (6'0" x 2'3") 1.76m x 0.69m (5'9" x 2'3")	1.83m x 0.61m (6'0" x 2'0")	1.80m x 1.12m (5'11" x 3'8")

LOIRE FEATURES

Along with the Swift Superior Standard (see page 4), Loire comes with many desirable extras including:



Sofa Bed



TV Point



Cooker



Wardrobe



Bay Window

*Model dependent





Duvalay mattresses
on all beds

FEATURES

EXTERIOR

- Fusion galvanised chassis with finish warranted for ten years
- Bonded sandwich exterior wall construction for greater strength
- Coated steel pantile roof
- Distinctive pre-coated 'folded' steel bargeboards
- Sandy Beige woodgrain textured aluminium cladding
- White uPVC windows with push-button security locks
- PVC gutters and down pipes
- Low energy exterior side light

INSULATION

- Excellent thermal performance:
 - 50mm insulation in floor
 - 90mm insulation in roof
 - 30mm insulation in walls
 - Lagged underfloor pipes

INTERIOR

- **NEW** Wesley soft furnishings
- Luxury carpet with underlay
- **NEW** Tournai Stone effect vinyl flooring in kitchen/dining/bathroom(s)
- Tisano Oak woodgrain (with **NEW** Bronze Chromix feature panels)
- Low energy LED lighting throughout
- USB sockets
- Double electric sockets throughout
- Hallway door (35' and 38' x 12' models)

LOUNGE

- Front bay window giving panoramic views and more comfortable front seating
- Fixed L-shape sofa with fold out occasional bed and loose back cushions
- Coffee table (except 10ft models)
- Lined curtains with tiebacks with **NEW** curtain poles
- TV point with Co-Ax and 240V socket

KITCHEN / DINING

- Thetford glass fronted oven and grill with electronic ignition
- Four-burner gas hob with electronic ignition
- Externally vented stainless steel cooker hood
- Integrated microwave oven (800w)*
- Integrated fridge and freezer (12' models)

- **NEW** under counter fridge (10' models)
- **NEW** Silver Chromix 30mm laminate worktops with matching upstands
- **NEW** stainless steel bar handles for kitchen cupboards
- Stainless steel sink/drainer
- Freestanding dining table with fixed style seating and two stools

BATHROOM(S)

- Shower cubicle with thermostatic shower in main bathroom
- Dual flush WC
- LED vanity spotlights
- Extractor fan in main bathroom

BEDROOMS

- **NEW** deeper and more luxurious Aurora Duvalay™ mattress to all beds with Crib 5 rated fabric
- Avola woodgrain headboards
- Gazunda bed in one twin bedroom for extra space (one bed stores under the other when not required)
- Bedside shelf units and overbed storage
- Contemporary handleless furniture design and feature panels in **NEW** Bronze Chromix
- Vanity area with mirror and socket
- TV sockets & Co-Ax to all bedrooms plus booster (except 28' x 12' 2B)

OPTIONS

- Thermaglas uPVC double glazing
- Condensing gas combi-boiler central heating and hot water system;
 - Radiator in en suite
 - Radiator thermostats
- Environmental exterior with green window frames
- Environmental exterior with anthracite grey window frames
- Freestanding dining table and freestanding chairs
- Wireless programmable room thermostat
- Electric fire
- Bluetooth® audio connection to lounge ceiling speakers
- Shaving socket in bathroom
- SwiftShield stain resistant fabric

FLOORPLANS

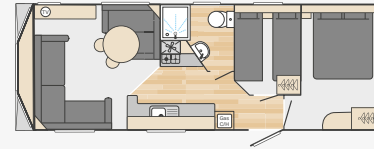

28' x 10' - 2 Bedroom



28' x 12' - 2 Bedroom

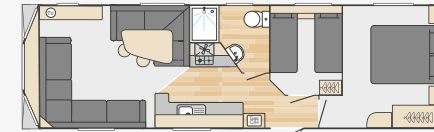

32' x 10' - 2 Bedroom



32' x 12' - 2 Bedroom



35' x 12' - 2 Bedroom

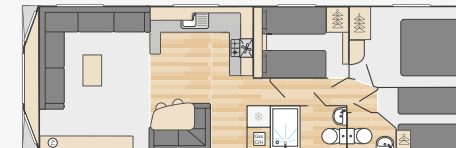

35' x 12' - 3 Bedroom

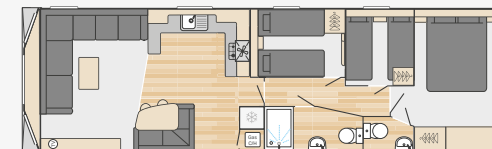

38' x 12' - 3 Bedroom

*The model fitted may differ from that shown in images, please check with supplying dealer or park



Developed for family life, the great-value Ardennes has a spacious yet cosy atmosphere alongside easy-clean furnishings and ample storage. Combining great specification with the utmost practicality, this sought-after holiday home is bright and hardwearing, from the fresh interior scheme to the robust fittings.

Model size	Bedrooms	Main bed	Twin beds	Rear twin beds	Sofa bed
28' x 12'	2	1.91m x 1.37m (6'3" x 4'6")	1.83m x 0.69m (6'0" x 2'3")	N/A	1.80m x 1.12m (5'11" x 3'8")
			1.76m x 0.69m (5'9" x 2'3")		
32' x 12'	2	1.91m x 1.37m (6'3" x 4'6")	1.83m x 0.69m (6'0" x 2'3")	N/A	1.80m x 1.12m (5'11" x 3'8")
			1.76m x 0.69m (5'9" x 2'3")		
35' x 12'	2	1.91m x 1.37m (6'3" x 4'6")	1.83m x 0.69m (6'0" x 2'3")	N/A	1.80m x 1.12m (5'11" x 3'8")
			1.76m x 0.69m (5'9" x 2'3")		
35' x 12'	3	1.91m x 1.37m (6'3" x 4'6")	1.83m x 0.69m (6'0" x 2'3")	1.83m x 0.61m (6'0" x 2'0")	1.80m x 1.12m (5'11" x 3'8")
			1.76m x 0.69m (5'9" x 2'3")		
38' x 12'	2	1.91m x 1.37m (6'3" x 4'6")	1.83m x 0.69m (6'0" x 2'3")	N/A	1.80m x 1.12m (5'11" x 3'8")
			1.76m x 0.69m (5'9" x 2'3")		
38' x 12'	3	1.91m x 1.37m (6'3" x 4'6")	1.83m x 0.69m (6'0" x 2'3")	1.83m x 0.61m (6'0" x 2'0")	1.80m x 1.12m (5'11" x 3'8")
			1.76m x 0.69m (5'9" x 2'3")		
38' x 12'	2 ES	1.91m x 1.37m (6'3" x 4'6")	1.83m x 0.69m (6'0" x 2'3")	N/A	1.80m x 1.12m (5'11" x 3'8")
			1.76m x 0.69m (5'9" x 2'3")		

ARDENNES FEATURES

Along with the Swift Superior Standard (see page 4), Ardennes comes with many desirable extras including:



Sofa Bed



TV Point



Cooker



Wardrobe



Electric Fire



Double Glazing



Central Heating
Boiler



Contemporary electric fire

Luxury carpet



Low energy LED lighting



L-shape sofa with fold out occasional bed



FEATURES

EXTERIOR

- Fusion galvanised chassis with finish warranted for ten years
- Bonded sandwich exterior wall construction for greater strength
- Coated steel pantile roof
- Distinctive pre-coated 'folded' steel bargeboards with LED lighting to front aspect
- Sandy Beige woodgrain textured aluminium cladding
- White uPVC windows with push-button security locks
- PVC gutters and down pipes
- Low energy exterior side light

INSULATION

- Excellent thermal performance:
 - 'Thermaglas' uPVC double glazing
 - 50mm insulation in floor
 - 90mm insulation in roof
 - 30mm insulation in walls
 - Lagged underfloor pipes

INTERIOR

- Opulence soft furnishing scheme
- Luxury lounge carpet with underlay
- Laminate effect vinyl flooring in kitchen/dining/bathroom(s)
- Tisano Oak woodgrain
- Condensing gas combi-boiler central heating and hot water system with radiator thermostat
- Low energy LED lighting throughout
- USB sockets
- Double electric sockets throughout
- Hallway door (except 28' x 12' model)

LOUNGE

- Full length window
- Fixed L-shape sofa with fold out occasional bed and loose back cushions
- TV point with Co-Ax and 240V socket
- Electric fire
- Window next to fireplace (35' & 38' x 12' models only)
- Lined curtains with tiebacks
- Coffee table

KITCHEN / DINING

- Thetford Cocina glass fronted oven, grill and electronic ignition with improved door function, higher temperatures, burner rating and heat-up times
- Four-burner gas hob with electronic ignition and glass splashback
- White externally vented cooker extractor fan
- Integrated microwave oven (800w)*
- Integrated fridge and freezer
- 30mm Chicago Concrete laminate worktops with matching upstands
- Stainless steel sink/drain
- Freestanding dining table and chairs (two additional folding chairs in 3 bed models)

BATHROOM(S)

- Shower cubicle with thermostatic shower in main bathroom
- LED vanity spotlights
- Dual flush WC
- Towel radiator in main bathroom
- Radiator in en suite
- Extractor fan in main bathroom

BEDROOMS

- **NEW** deeper and more luxurious Aurora Duvalay™ mattress to all beds with Crib 5 rated fabric
- Fabric headboard(s)
- Gazunda bed in one twin bedroom for extra space (one bed stores under the other when not required)
- Contemporary handleless furniture design and feature panels
- Bedside shelf units and overbed storage
- Vanity area with mirror and socket in main bedroom
- TV sockets & Co-Ax to all bedrooms plus booster

OPTIONS

- Front aspect French doors
- Environmental exterior with anthracite grey window frames
- Wireless programmable room thermostat
- Bluetooth® audio connection to lounge ceiling speakers
- **NEW** twin room USB sockets
- Shaving socket in bathroom
- SwiftShield stain resistant fabric

FLOORPLANS



28' x 12' - 2 Bedroom

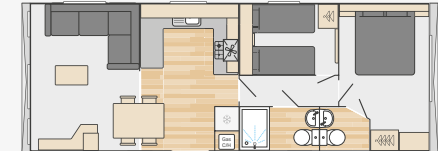

32' x 12' - 2 Bedroom



35' x 12' - 2 Bedroom



35' x 12' - 3 Bedroom

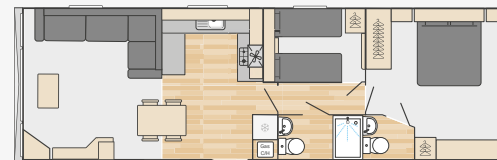

38' x 12' - 2 Bedroom

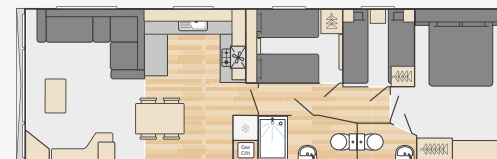

38' x 12' - 3 Bedroom

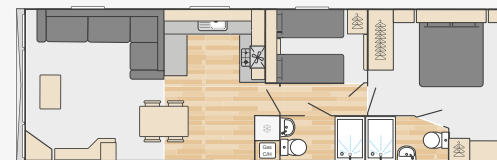

38' x 12' ES - 2 Bedroom

*The model fitted may differ from that shown in images, please check with supplying dealer or park

THE RANGE AT A GLANCE

	VENDEE	ANTIBES	MOSELLE	BORDEAUX ESCAPE	BORDEAUX	BURGUNDY	LOIRE	ARDENNES
Exterior								
Fusion chassis with galvanised finish warranted for 10 years	•	•	•	•	•	•	•	•
Bonded 'sandwich' exterior wall construction	•	•	•	•	•	•	•	•
Coated steel pantile roof	•	•	•	•	•	•	•	•
Distinctive 'folded' steel bargeboards with lighting	•	•	•	Under canopy lighting	•	•	No lights	•
Woodgrain textured aluminium cladding	•	•	•	•	•	•	•	•
Front aspect doors	French	Optional (S)	Optional (F)	Sliding	Optional (S)	Optional (F)		Optional (F)
uPVC windows with push-button security locks	•	•	•	•	•	•	•	•
PVC gutters and down pipes	•	•	•	•	•	•	•	•
Low energy exterior light	•	•	•	•	•	•	•	•
Environmental exterior	Optional	Optional	Optional	Optional	Optional	Optional	Optional	Optional
Insulation								
'Thermaglas' uPVC double glazing	•	Optional	Optional	Optional	Optional	Optional	Optional	•
Insulation thickness in floor	50mm	50mm	50mm	50mm	50mm	50mm	50mm	50mm
Insulation thickness in roof	90mm	90mm	90mm	90mm	90mm	90mm	90mm	90mm
Insulation thickness in walls	30mm	30mm	30mm	30mm	30mm	30mm	30mm	30mm
Lagged underfloor pipes	•	•	•	•	•	•	•	•
Interior								
Condensing gas combi-boiler central heating and hot water system (GCH)	•	Optional	Optional	Optional	Optional	Optional	Optional	•
Radiator thermostats (with central heating)	•	Inc with GCH option	Inc with GCH option	Inc with GCH option	Inc with GCH option	Inc with GCH option	Inc with GCH option	•
Gas water heater		•	•	•	•	•	•	
Luxury carpet with underlay throughout	•	•	•	•	•	•	•	•
Heavy duty, durable vinyl flooring in uncarpeted rooms	•	•	•	•	•	•	•	•
Low energy LED lighting throughout	•	•	•	•	•	•	•	•
Planked interior ceiling system		•		•				
USB double socket	•	•	•	•	•	•	•	•
Woodgrain	Nebraska Oak	Tisano Oak	Nebraska Oak	Nebraska Oak	Nebraska Oak	Nebraska Oak	Tisano Oak	Tisano Oak
SwiftShield stain resistant fabric	Optional	Optional		Optional	Optional	Optional	Optional	
Wireless programmable room thermostat with gas central heating	Optional	Optional	Optional	Optional	Optional	Optional	Optional	Optional
Lounge								
Freestanding sofas with scatter cushions	•	•	•	•	•			
Fixed sofas with scatter cushions						•	•	•
Pull-out sofa bed mechanism	Optional	•	Optional	•	•	•	•	•
2 upholstered cube stools stored under coffee table	Footstool with storage	•		•	•			
Coffee table		•	•	•	•	•	Except 10ft Models	•
Contemporary electric fire	•					•	Optional	•
Provision for Sky+ connection	•	•						
Bluetooth audio connection to lounge ceiling speaker	Optional	Optional	Optional	Optional	Optional	Optional	Optional	Optional
Framed wall pictures	1	1		Framed Mirror	Framed Mirror	1		

	VENDEE	ANTIBES	MOSELLE	BORDEAUX ESCAPE	BORDEAUX	BURGUNDY	LOIRE	ARDENNES
Kitchen/dining								
Glass fronted oven and grill with electronic ignition	•	•	•	•	•	•	•	•
Stainless steel cooker hood with extractor vented to outside	•	Black angled	Built in	•	•	•	•	White
4-burner gas hob with electronic ignition	5-burner inc wok burner	•	•	•	•	•	•	•
Integrated fridge and freezer	•	•	•	•	•	•	12' models	•
Under counter fridge							10' models	
Microwave oven	•	•	•	•	•	•	•	•
'A' rated integrated 12 place setting dishwasher (if washing machine not fitted)	Optional	Optional	Optional Slimline	Optional Slimline	Optional Slimline			
Built-in washing machine with furniture door (if dishwasher not fitted)	Optional	Optional						
Stainless steel sink/drainer	White Resin Bowl & Drainer	1½ sinks	White or Black Cast Resin Bowl & Drainer	White Resin Bowl & Drainer	White Resin Bowl & Drainer	•	•	•
Laminate worktops with matching upstands	40mm	40mm	40mm	40mm	40mm	40mm	30mm	30mm
Soft shut drawers	•	•		•	•			
Under cupboard worktop feature lighting		•						
Fixed dinette			•			•	•	
Freestanding dining suite	•	•		•	•			•
Washrooms								
Shower cubicle with thermostatic shower in main bathroom	+ Ensuite	•	•	•	•	•	•	•
Dual flush WC	•	•	•	•	•	•	•	•
Extractor fan in main bathroom	+ Ensuite	•	+ All shower rooms	•	•	•	•	•
Towel radiator in shower rooms	•	Inc with GCH option	Inc with GCH option	Inc with GCH option	Inc with GCH option	Inc with GCH option	Inc with GCH option	•
Radiator in en suite	•	Inc with GCH option	Inc with GCH option	Inc with GCH option	Inc with GCH option	Inc with GCH option	Inc with GCH option	•
LED vanity lighting	•	•	•	•	•	•	•	•
Shower cubicle topper	With LED light	With LED light	With LED light	With LED light	With LED light	•	•	•
Shaver socket in bathroom	Optional	Optional	Optional	Optional	Optional	Optional	Optional	Optional
Bedrooms								
King-size double bed in main bedroom (except 33' 2 bed Bordeaux and 3 bed models)	•	•	•		•			
Lift-up bed allowing easy access to storage area	•	•	•	•	•			
One bed stores under the other for extra space in one twin bedroom						•	•	•
Duvalay™ Crib 5 mattress	•	•	•	•	•	•	•	•
Padded headboard(s)	Main bed	•		•	•			
Reading lights	•	•	•	•	•			
TV sockets & Co-Ax to all bedrooms plus booster	•	•	•	•	•	Except 28ft models	Except 29ft models	•
Safety								
Smoke alarm with 10-year battery	•	•	•	•	•	•	•	•
5-year carbon monoxide detectors	•	•	•	•	•	•	•	•
Fire extinguisher	•	•	•	•	•	•	•	•

THE SWIFT DIFFERENCE

As a leading manufacturer of holiday homes, touring caravans and motorhomes, we know just how to create the perfect retreat for your getaways. We apply this design and innovation excellence to all of our products, taking the time to understand what makes your breaks so special. We incorporate this understanding in superb specifications, impeccable looks and creative space solutions - and because we work with some of the industry's most trusted suppliers, you can be assured that everything is of the highest standard both inside and out.



CONSTRUCTION AND HIGH THERMAL EFFICIENCY

Swift's holiday home range is built to BS EN 1647, and meets the National Caravan Council (NCC) Structural Thermal Rating Scheme for Caravan Holiday Homes, which gives an indication of the likely thermal efficiency of the holiday home.

Swift's lodge range is built to BS 3632, and meets the NCC Energy Efficiency Rating Scheme for Residential Park Homes. This specification sets a higher standard for thermal efficiency through improvements in roof, wall and floor insulation.

DOUBLE GLAZING

In response to the demand for more energy-conscious living, heat reflecting 'Thermaglas' double glazing with a 16mm air space is fitted as standard or as an option on our holiday home ranges. All lodges are fitted with 'Thermaglas' as standard.

CHASSIS

Swift only specify fully galvanised chassis as standard. What's more, every Swift holiday home and lodge comes with a 10-year anti-corrosion warranty.

ROOF TRUSSES

For accuracy, strength and reliability, all Swift holiday homes and lodges use prefabricated roof trusses. The resulting roof strength meets Grade B snow loading (capable of carrying half a metre of settled snow), while a minimum of 90mm glass wool insulation in holiday homes, and 200mm in lodges, provides excellent thermal efficiency.

ENVIRONMENTAL CHAMBER TEST

Swift tests its holiday homes in an environmental chamber to optimise the heating and ventilation levels and measure thermal performance. Thermal imaging helps to ensure the products are fully designed and engineered to meet the requirements of a modern holiday home.

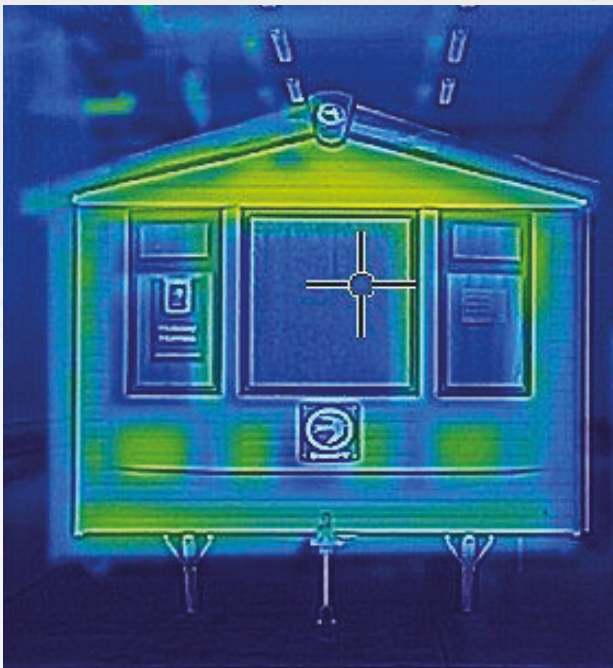

WALL CONSTRUCTION

All Swift holiday homes and lodges benefit from bonded 'sandwich' exterior wall construction for greater structural strength. The walls are made in modules approximately 3m x 2m and are clad with aluminium, CanExel and Corelux. Each module consists of a robust timber frame, battened out and filled with insulation and a plywood inner skin. For lodges, the outer surface is constructed of a breathable moisture membrane.

FLOOR CONSTRUCTION

The flooring in Swift holiday homes is constructed from timber joists much like a traditional home. Class-leading 50mm glass wool insulation is placed between the joists and the floor is covered with a breathable membrane and with a waterproof finish for durability.

In Swift lodges, the thermal efficiency is enhanced with Structural Insulated Panel (SIPs) flooring, consisting of a timber frame with floorboards either side, which is injected with polyurethane, giving a greater level of insulation for all year round living.

SAFETY COMES FIRST

All our holiday homes and lodges are built in accordance with British and European standards and are audited against these build standards by the National Caravan Council (NCC).



DIMENSIONS

- L1** Overall length including detachable towbar
- L2** Overall length excluding detachable towbar
- L3** Body length (including bay where applicable)
- L4** Body length at floor level
- W1** Overall width including gutters and down pipes
- W2** Width at floor level
- H1** Overall height

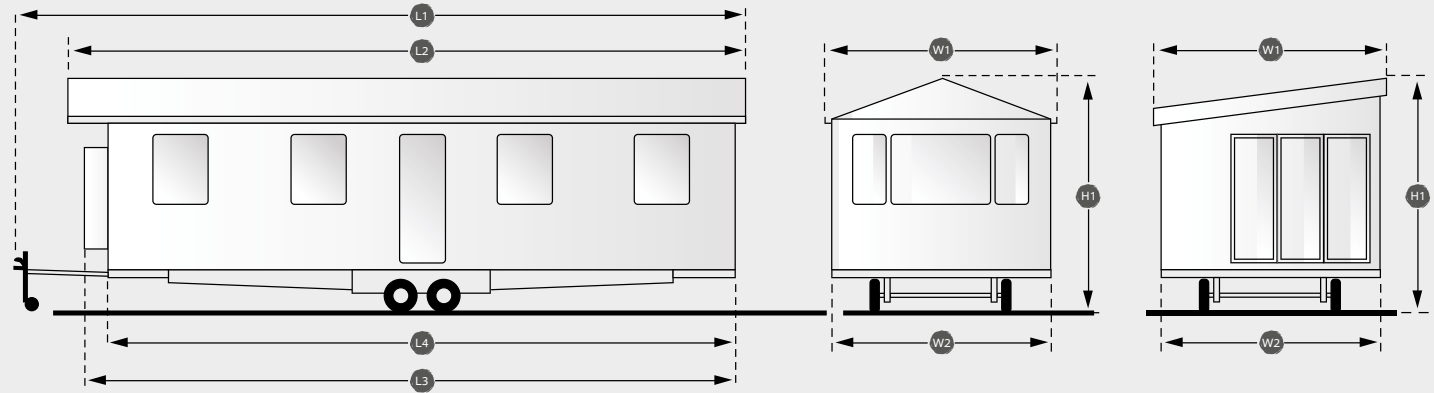

Model	L1	L2	L3	L4	W1	W2	H1
Vendee 40x12-2 bed	13.38m (43'11")	12.81m (42'0")	12.39m (40'8")	12.39m (40'8")	3.96m (13'0")	3.70m (12'2")	3.62m (11'11")
Antibes 39x12-2 bed	12.90m (42'4")	12.30m (40'4")	11.89m (39'0")	11.88m (39'0")	3.96m (13'0")	3.70m (12'2")	3.62m (11'11")
Antibes 40x12-3 bed	13.38m (43'11")	12.60m (41'4")	12.39m (40'8")	12.25m (42'2")	3.96m (13'0")	3.70m (12'2")	3.62m (11'11")
Moselle 35x12-2 bed	11.61m (38'1")	11.35m (37'3")	10.93m (35'10")	10.93m (35'10")	3.96m (13'0")	3.70m (12'2")	3.62m (11'11") Est.
Moselle 38x12-2 bed	12.41m (40'9")	12.15m (39'11")	11.74m (38'6")	11.74m (38'6")	3.96m (13'0")	3.70m (12'2")	3.62m (11'11") Est.
Moselle 40x12-3 bed	12.90m (42'4")	12.64m (41'6")	12.23m (40'2")	12.23m (40'2")	3.96m (13'0")	3.70m (12'2")	3.62m (11'11") Est.
Bordeaux Escape 38x12-2 bed	12.90m (42'4")	11.87m (38'11")	10.09m (33'1")	10.09m (33'1")	3.96m (13'0")	3.70m (12'2")	3.62m (11'11")
Bordeaux Escape 41x12-3 bed	13.51m (44'4")	12.72m (41'9")	10.93m (35'10")	10.93m (35'10")	3.96m (13'0")	3.70m (12'2")	3.62m (11'11")
Bordeaux 33x12-2 bed	11.53m (37'10")	10.50m (34'5")	10.09m (33'1")	10.09m (33'1")	3.96m (13'0")	3.70m (12'2")	3.62m (11'11")
Bordeaux 35x12-2 bed	11.55m (37'11")	11.35m (37'3")	10.93m (35'10")	10.93m (35'10")	3.96m (13'0")	3.70m (12'2")	3.62m (11'11")
Bordeaux 38x12-2 bed	12.90m (42'4")	12.15m (39'11")	11.75m (38'7")	11.75m (38'7")	3.96m (13'0")	3.70m (12'2")	3.62m (11'11")
Bordeaux 38x12-2 bed ES	12.90m (42'4")	12.15m (39'11")	11.75m (38'7")	11.75m (38'7")	3.96m (13'0")	3.70m (12'2")	3.62m (11'11")
Bordeaux 38x12-3 bed	12.90m (42'4")	12.15m (39'11")	11.75m (38'7")	11.75m (38'7")	3.96m (13'0")	3.70m (12'2")	3.62m (11'11")
Burgundy 29x12-2 bed	9.78m (32'1")	9.32m (30'7")	8.90m (29'2")	8.90m (29'2")	3.96m (13'0")	3.70m (12'2")	3.41m (11'2")
Burgundy 33x12-2 bed	10.92m (35'10")	10.46m (34'4")	10.05m (33'0")	10.05m (33'0")	3.96m (13'0")	3.70m (12'2")	3.41m (11'2")
Burgundy 36x12-2 bed	12.08m (39'7")	11.62m (38'1")	11.20m (36'9")	11.20m (36'9")	3.96m (13'0")	3.70m (12'2")	3.41m (11'2")
Burgundy 36x12-3 bed	12.08m (39'7")	11.62m (38'1")	11.20m (36'9")	11.20m (36'9")	3.96m (13'0")	3.70m (12'2")	3.41m (11'2")
Burgundy 38x12-3 bed	12.57m (41'3")	12.12m (39'9")	11.72m (38'5")	11.45m (37'7")	3.96m (13'0")	3.70m (12'2")	3.41m (11'2")
Loire 28x10-2 bed	9.25m (30'4")	9.10m (29'10")	8.87m (29'1")	8.63m (28'4")	3.35m (11'0")	3.05m (10'0")	3.29m (10'10")
Loire 28x12-2 bed	9.25m (30'4")	9.10m (29'10")	8.87m (29'1")	8.63m (28'4")	3.96m (13'0")	3.70m (12'2")	3.41m (11'2")
Loire 32x10-2 bed	10.39m (34'1")	10.25m (33'7")	10.05m (33'0")	9.77m (32'1")	3.35m (11'0")	3.05m (10'0")	3.29m (10'10")
Loire 32x12-2 bed	10.39m (34'1")	10.25m (33'7")	10.05m (33'0")	9.77m (32'1")	3.96m (13'0")	3.70m (12'2")	3.41m (11'2")
Loire 35x12-2 bed	11.55m (37'11")	11.40m (37'5")	11.21m (36'9")	10.94m (35'11")	3.96m (13'0")	3.70m (12'2")	3.41m (11'2")
Loire 35x12-3 bed	11.55m (37'11")	11.40m (37'5")	11.21m (36'9")	10.94m (35'11")	3.96m (13'0")	3.70m (12'2")	3.41m (11'2")
Loire 38x12-3 bed	12.54m (41'2")	12.20m (40'0")	12.00m (39'5")	11.73m (38'6")	3.96m (13'0")	3.70m (12'2")	3.41m (11'2")
Ardennes 28x12-2 bed	9.60m (31'6")	9.14m (30'0")	8.72m (28'7")	8.72m (28'7")	3.96m (13'0")	3.70m (12'2")	3.41m (11'2")
Ardennes 32x12-2 bed	10.67m (35'0")	10.21m (33'6")	9.79m (32'1")	9.79m (32'1")	3.96m (13'0")	3.70m (12'2")	3.41m (11'2")
Ardennes 35x12-2 bed	11.81m (38'9")	11.35m (37'3")	10.93m (35'10")	10.93m (35'10")	3.96m (13'0")	3.70m (12'2")	3.41m (11'2")
Ardennes 35x12-3 bed	11.81m (38'9")	11.35m (37'3")	10.93m (35'10")	10.93m (35'10")	3.96m (13'0")	3.70m (12'2")	3.41m (11'2")
Ardennes 38x12-2 bed	12.61m (41'5")	12.15m (39'11")	11.75m (38'7")	11.75m (38'7")	3.96m (13'0")	3.70m (12'2")	3.41m (11'2")
Ardennes 38x12-3 bed	12.61m (41'5")	12.15m (39'11")	11.75m (38'7")	11.75m (38'7")	3.96m (13'0")	3.70m (12'2")	3.41m (11'2")
Ardennes 38x12-2 bed ES	12.61m (41'5")	12.15m (39'11")	11.75m (38'7")	11.75m (38'7")	3.96m (13'0")	3.70m (12'2")	3.41m (11'2")

Est. = Estimate

SWIFT WARRANTY SCHEME

You can rest assured that your Swift holiday home comes with a comprehensive warranty, allowing you to simply relax and enjoy your home.



3-YEAR SUPERSURE WARRANTY

Your holiday home has 3-year cover for all parts and fittings (other than the structural exterior).

This includes items like:

- Freestanding furniture
- Kitchens
- Showers
- Sanitaryware
- Sockets and switches
- Interior doors and integrated furniture
- Gutter and fall pipes



5-YEAR STRUCTURAL WARRANTY

Your holiday home has a 5-year Structural Warranty and Swift will repair (or, at its option, replace) any defects with the structural integrity of the home that come to light and are notified to Swift during the warranty period.

The Structural Warranty covers any defect with the seams of the home, including water ingress through any permanently sealed seam joints and also items like:

- External doors
- uPVC windows
- Roof, walls and ceilings
- Carpets



10-YEAR CHASSIS WARRANTY

Your holiday home has a fully galvanised chassis with a 10-year Chassis Warranty, subject to maintenance. Swift will repair (or, at its option, replace) any defects with the chassis that come to light during this period, but only for as long as the home belongs to its first owner.

All warranties start from the date an approved Swift Group dealer or park operator transfers the unit to its first owner and are subject to conditions, terms and exclusions. For full details see www.swiftgroup.co.uk/owners/handbooks



EXTERIOR FINISHES & SOFT FURNISHINGS

Swift holiday homes are designed for long-lasting great looks, both inside and out. The exterior is woodgrain textured aluminium cladding.

SANDY BEIGE



ENVIRONMENTAL GREEN



WOODGRAIN TEXTURED ALUMINIUM	SANDY BEIGE	ENVIRONMENTAL GREEN
Models		
VENDEE	•	•
ANTIBES	•	•
MOSELLE	•	•
BORDEAUX ESCAPE	•	•
BORDEAUX	•	•
BURGUNDY	•	•
LOIRE	•	•
ARDENNES	•	•



Standard exterior finish



Optional exterior finish

SWIFTSHIELD

Selected Swift holiday homes are available with the exclusive option of SwiftShield fabric. SwiftShield fabric has a soft suede-type feel and has been cleverly treated during manufacturing to resist stains. It is very easy to clean and requires only a soft cloth dampened with water to remove most stains.

For full details, please go to www.swiftgroup.co.uk

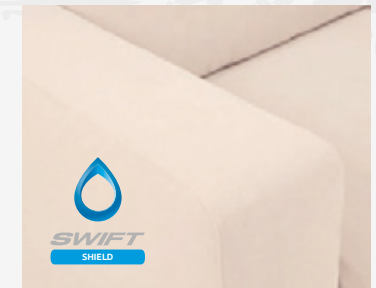

COMPARE AT A GLANCE	VENDEE	ANTIBES	BORDEAUX & BORDEAUX ESCAPE	BURGUNDY	LOIRE
SwiftShield Colour Options					
LATTE (908)	•		•		•
STONE (960)	•			•	•
PEBBLE (976)		•			
DOVE (77)		•			

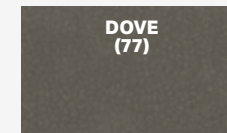
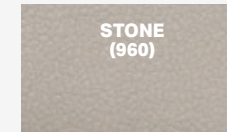
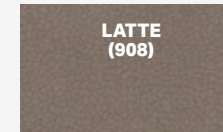



ONLY SWIFT APPROVED PARTNERS SELL APPROVED SWIFT HOLIDAY HOMES AND LODGES

Swift wants to make sure your buying experience is the best it can be. When you buy from a Swift Approved Partner, you can rest assured that your holiday home is fully supported by Swift Group and the supplying distributor.

The benefits of buying from a Swift Approved Partner include:

- Swift Group Approved Warranty
- Dealer access to Swift Connect aftersales support
- Approved spare parts
- Approved engineers
- Access to Swift Approved technical engineers
- Product on display at distributors
- Financial services to help with your purchase*

Find your nearest Swift Approved Partner from our list on the back of the brochure or the Swift Group website, www.swiftgroup.co.uk, and look out for the Swift Approved Partner signs in dealerships.

* Subject to status



Find out more at swiftgroup.co.uk



Brochures



Layouts



Dealer



Social

A person is splashing water in the ocean at sunset. The water is captured in mid-air, creating a large splash on the left side of the frame. The person's arm is raised on the right side. The background is a bright, hazy sky with a warm orange and yellow glow from the setting sun. The water in the foreground is dark blue with white foam from the splash. The overall mood is joyful and summery.

Love life

LOVE SWIFT





SWIFT
CREATING SMILES FOR LIFE

DEALERS

Cumbria

Kendal Caravans
Kendal
Tel: 01539 823659
kendalcaravans.co.uk

Devon

Surf Bay Leisure
Winkleigh
Tel: 01837 680100
surfbayleisure.co.uk

Dorset

Surf Bay Leisure
Bridport
Tel: 01308 427444
surfbayleisure.co.uk

Durham

Ideal Caravans
Durham
Tel: 0191 378 0146
idealcaravans.co.uk

East Midlands

Don Amott Leisure Kingdom
Derby
Tel: 01283 732193
donamottparks.com

Hampshire

PM Leisure
Hayling Island
Tel: 023 9246 7722
pmleisure.co.uk

Lancashire

Westfield Caravans
Blackpool
Tel: 01253 301505
westfieldcaravans.co.uk

Lincolnshire

Seymours Caravans
Skegness
Tel: 01754 764270
seymourscaravans.co.uk

TLC Skegness

Skegness
Tel: 01754 875050
theleisurecompany.co.uk

Norfolk

McDonnell Caravans
Kings Lynn
Tel: 01553 636243
mcdonnellcaravans.co.uk

Parklands Leisure

Wells-next-the-Sea
Tel: 01328 710166
parklandsleisure.co.uk

Pioneer Caravans

Peterborough
Tel: 01733 222244
pioneercaravans.co.uk

Shropshire

Salop Leisure Ltd
Shrewsbury
Tel: 01743 282400
salopleisure.co.uk

Somerset

Surf Bay Leisure
Bream
Tel: 01278 751171
surfbayleisure.co.uk

Yorkshire

Bridlington Caravan Centre
Bridlington
Tel: 01262 606777
bridlingtoncaravans.com

Yorkshire Holiday Homes

Wetherby
Tel: 01937 849128
yorkshirehh.co.uk

Northumberland

Ideal Caravans
Adderstone
Tel: 0191 378 6615
idealcaravans.co.uk

Worcestershire

Salop Leisure
Worcester
Tel: 01299 878872
salopleisure.co.uk

Northern Ireland

Sandycove Holiday Homes
Donaghadee
Tel: 028 4275 8200
sandycove.co.uk

Hayes Caravans

Dungannon
Tel: 028 7767575
hayescaravans.com

Ireland

Harry Farrell & Sons Ltd
Dublin
Tel: +353 (0)1 458 9410
harryfarrellsons.ie

Scotland

Swalwell Holiday Group
Gatehouse of Fleet
Tel: 01556 506 200
swalwellholidaygroup.co.uk

Dee Valley Caravans

Aberdeen
Tel: 01330 811351
deevalleycaravans.co.uk

Wales

Blackhills Caravan Sales
Gower
Tel: 01792 851221
blackhillscaravansales.co.uk

Lloyds Caravan & Lodge Sales

Towyn
Tel: 01745 832050
lloydscaravans.co.uk

Salop Leisure

Machynlleth
Tel: 01654 705900
salopleisure.co.uk

Mon Caravans

Anglesey
Tel: 01248 711070
moncaravans.com

Holland

Caravancentrum Roels
Tel: +32 (0)9 369 20 26
caravancentrumroels.be

Belgium

Caravancentrum Roels
Tel: +32 (0)9 369 20 26
caravancentrumroels.be

France

Picardy / Nord Pas de Calais
Caravancentrum Roels
Tel: +32 (0)9 369 20 26
caravancentrumroels.be

VISIT SWIFTGROUP.CO.UK



Layouts



Dealer



Video



Social



Brochures



SWIFT
APPROVED PARTNER

DISCLAIMER

This brochure does not constitute an offer by Swift Group Limited (Swift). Swift reserves the right to alter specifications and prices at any time as materials and conditions demand. Distributors and dealers sell Swift products on their own account and not as agents of Swift. Accordingly, they have no authority to bind Swift or to make any representation or undertaking whatsoever on behalf of Swift. All props are for photographic purposes only and are not included in the specification. Models shown may be fitted with optional extras. Issued August 2021.

CARAVANS • MOTORHOMES • HOLIDAY HOMES - MADE IN BRITAIN BY SWIFT